

Private Office Quickship QPO004

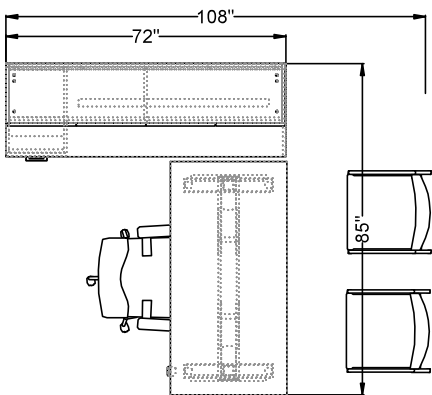

| # | Catalogue Part Number | Description | Quantity | Ext. List | |
|---|-----------------------|--|----------|--------------|-------------------|
| 1 | ZVS QGP0249SB | 49" Metal Support Rail for Work Surface 2W 49 L 3/4H - Quickship | 1 | \$88.00 | |
| 2 | ZST QGV1723 | Garvey R5 - R5 Back Style Management Adjustable Mid Back- 25d x 30w x 38-43.5h - Quickship | 1 | \$1,433.00 | |
| 3 | ZST QKN3001WJUS | Knox Straight Arm Chair - Wood Back/Uph. Seat - Quickship | 2 | \$1,972.00 | |
| 4 | ZVS QVST1624MFF | Vision 24d x 16w x 28h Modular File/File Pedestal - Quickship | 1 | \$759.00 | |
| 5 | ZVS QVST1672SO | Vision 72w Storage Overhead Cabinet w/Four Doors - Quickship | 1 | \$1,788.00 | |
| 6 | ZVS QVST23EP | Vision 22 7/8w x 28h Modular End Panel for Shell Desks and Credenzas - Quickship | 1 | \$199.00 | |
| 7 | ZVS QVST2472MCT | Vision 24 x 72 Modular Credenza Top - Quickship | 1 | \$469.00 | |
| 8 | ZVS QVST2872MBK | Vision Modular Desk or Credenza Overlay Back Panel - 3/4d x 71 7/8w x 28h - Quickship | 1 | \$331.00 | |
| 9 | ZVS QVST3060AHTD-S | Vision Laminate Adj Hgt Table Desk - Standard Range - 30d x 60w x Adj h - Quickship | 1 | \$1,346.00 | |
| | | | | Total | \$8,385.00 |

love what you do

Note: All prices are for budgetary purposes only. List prices are reflected and are subject to change. Prices effective 07.01.2024.