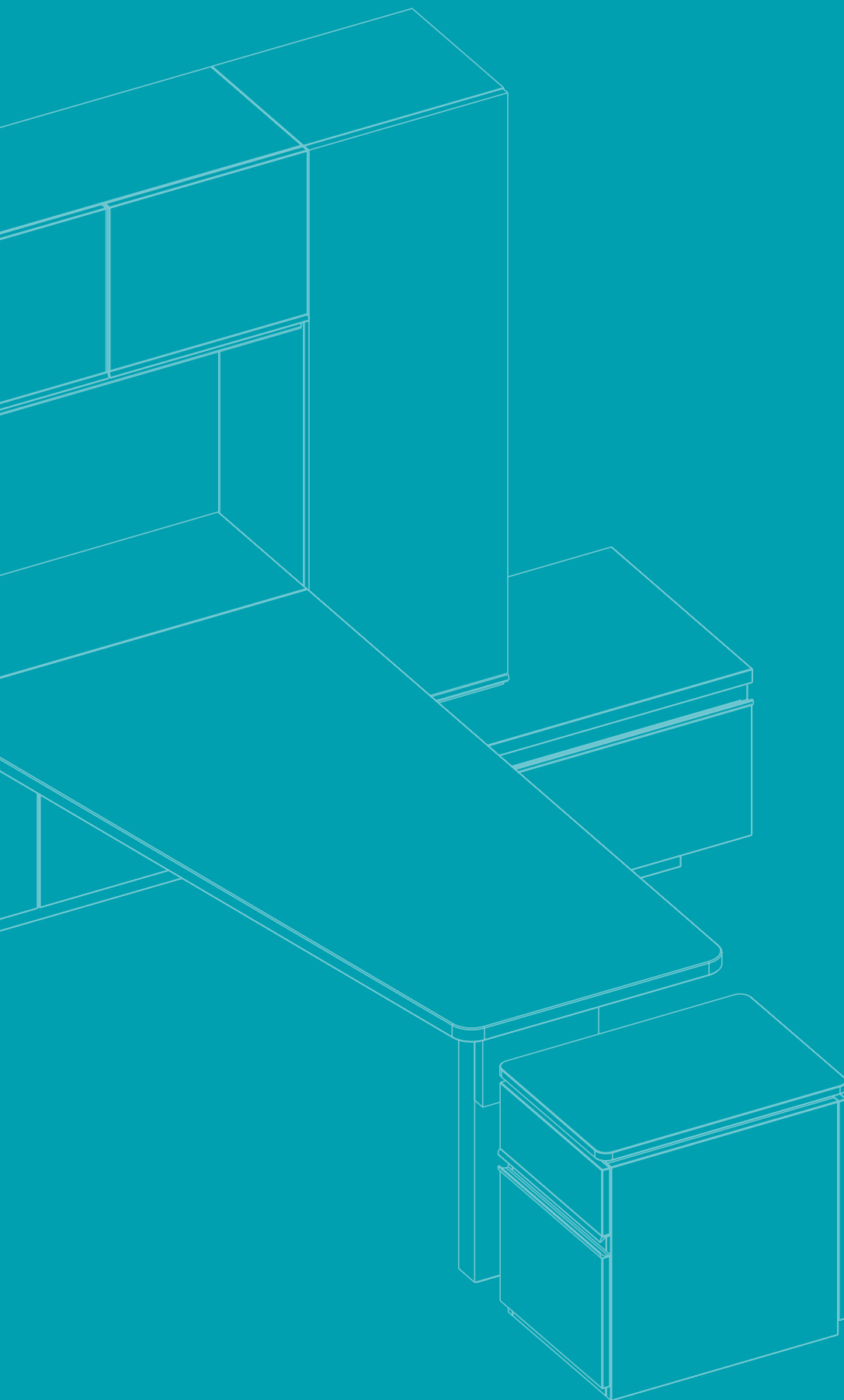




# Contents

- 02** Overview
- 04** Technology Accommodation
- 06** Design Steps
- 08** Idea Starters
- 16** Planning



## Overview – Architectural Walls

Architectural Walls can be specified with Open Shelves or Workcenters. Both offerings feature workflow solutions, and seamlessly integrate technology, filing, piling, reference and work tools.

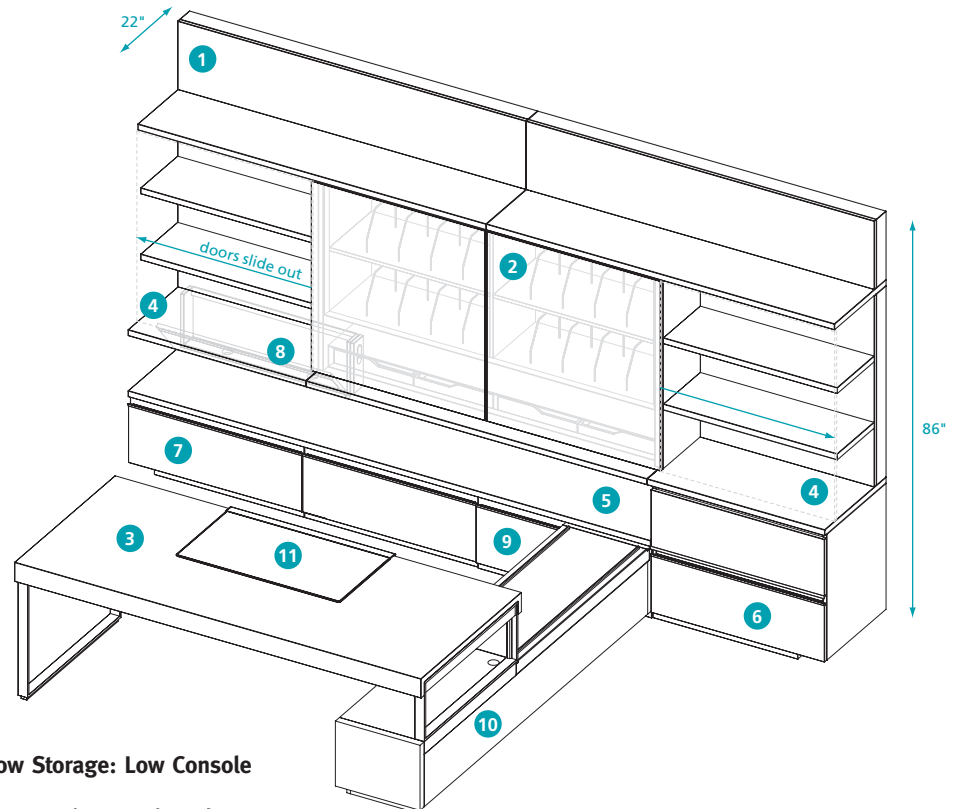
One height & one depth of workwall

Wall-mounted overhead storage using Workcenters (shown) or Shelves

Workwall Tops included

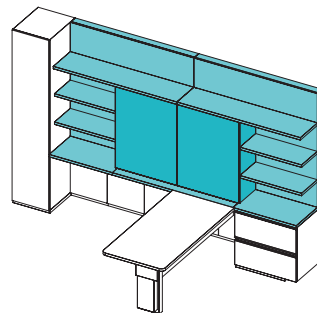
- 1 Architectural Wall with Workcenter
- 2 Workcenter
- 3 Desk
- 4 Workwall Top (included with Architectural Wall)
- 5 Workwall Top (order separately)
- 6 Low Storage: Two-high Lateral File
- 7 Low Storage: One-high Lateral File
- 8 Low Storage: Kneespace Access Panel, partial height
- 9 Low Storage: Low Console Connector

- 10 Low Storage: Low Console
- 11 Accessories: Desk Pad

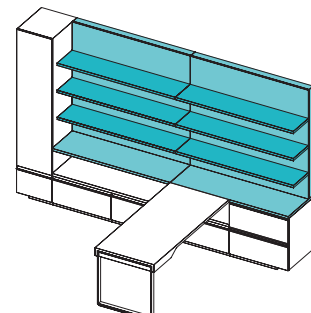


## Workcenters and Open Shelves

see page 16-18



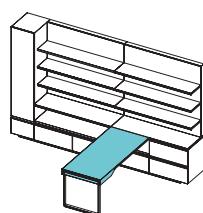
Workcenters (page 16)



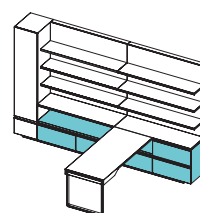
Open Shelves (page 17)

## Common Components

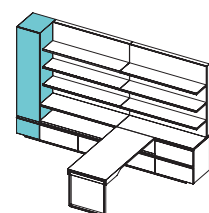
see page 22-34



Worksurfaces (page 22)



Low Storage (page 28)



Tall Storage (page 33)

## Overview – Casegood Walls

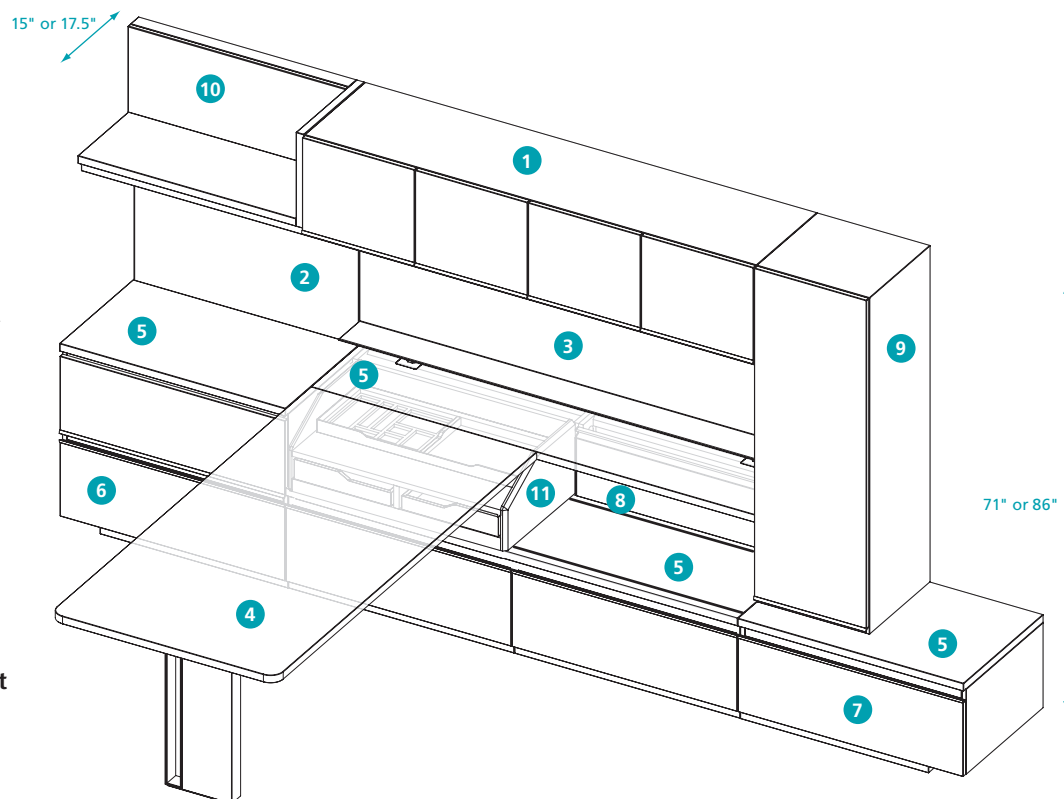
Casegood Walls feature modular wall components including overhead cabinets, asymmetric shelves, back panels and towers which together provide workflow and organizational solutions.

Two heights & two depths of workwall

Wall-mounted (shown) or Panel-supported Overheads

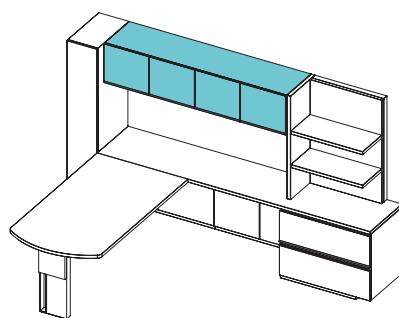
Workwall Tops specified separately

- 1 Overhead, wall-mounted**
- 2 Back Panel**
- 3 Back Panel with Mini-shelf**
- 4 Desk**
- 5 Workwall Tops**
- 6 Low Storage: Two-high Lateral File**
- 7 Low Storage: One-high Lateral File**
- 8 Low Storage: Kneespace Access Panel, partial height**
- 9 Tower**
- 10 Asymmetric Shelf**
- 11 Accessories: Piling Shuttle**

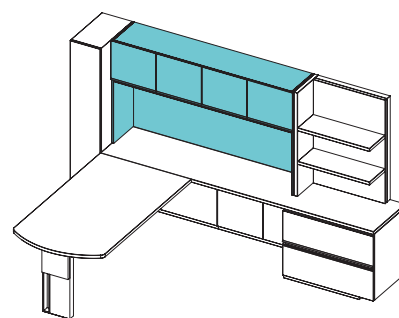


### Overheads, wall-mounted and panel-supported

see page 19-21



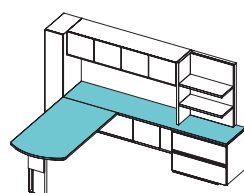
Wall-mounted Overheads (page 19)



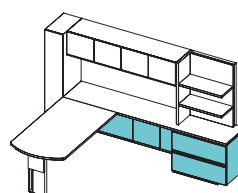
Panel-supported Overheads (page 19)

### Common Components

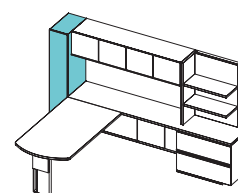
see page 22-34



Worksurfaces (page 22)



Low Storage (page 28)



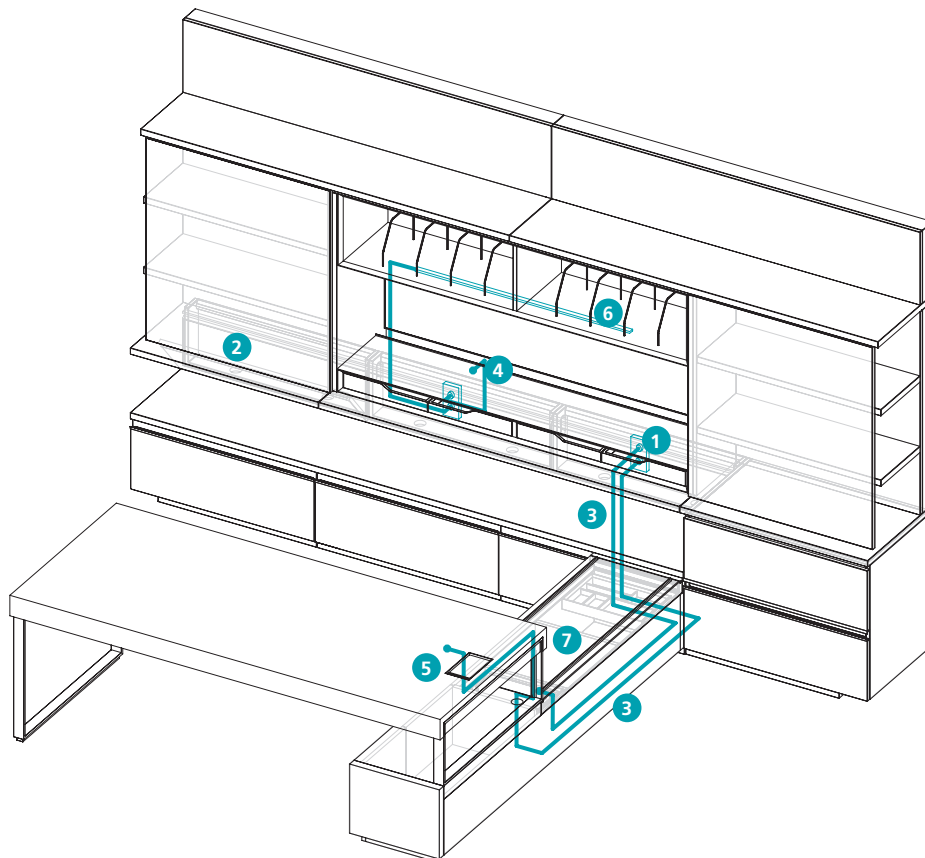
Tall Storage (page 33)

## Technology Accommodation – Architectural Walls

Apogee features a variety of technology solutions for today's user including charging trays and desk top power/data ports.

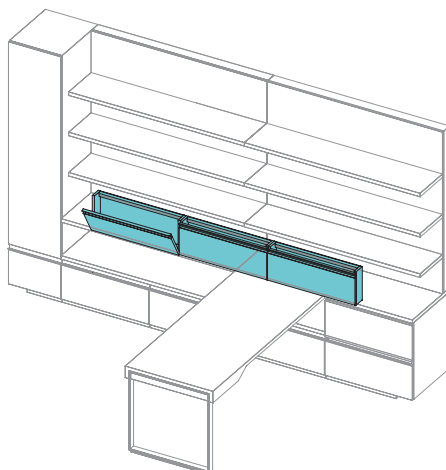
- 1 Building Power Source
- 2 Kneespace Access Panels, partial-height
- 3 Wire Management Chase
- 4 Work Surface Wire Drop into Access Panel
- 5 Power/Communication Port: Desks
- 6 LED Task Lights
- 7 Console Charging Tray for Electronic Devices

**Design Tip:** To ensure complete access to building power sources behind partial-height Kneespace Access Panels, locate centerline of wall outlets 24" AFF, and center within module width.

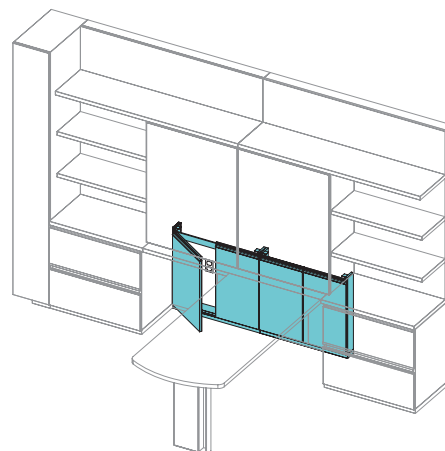


### Kneespace Access Panels

see page 30



Kneespace Access Panel, partial-height



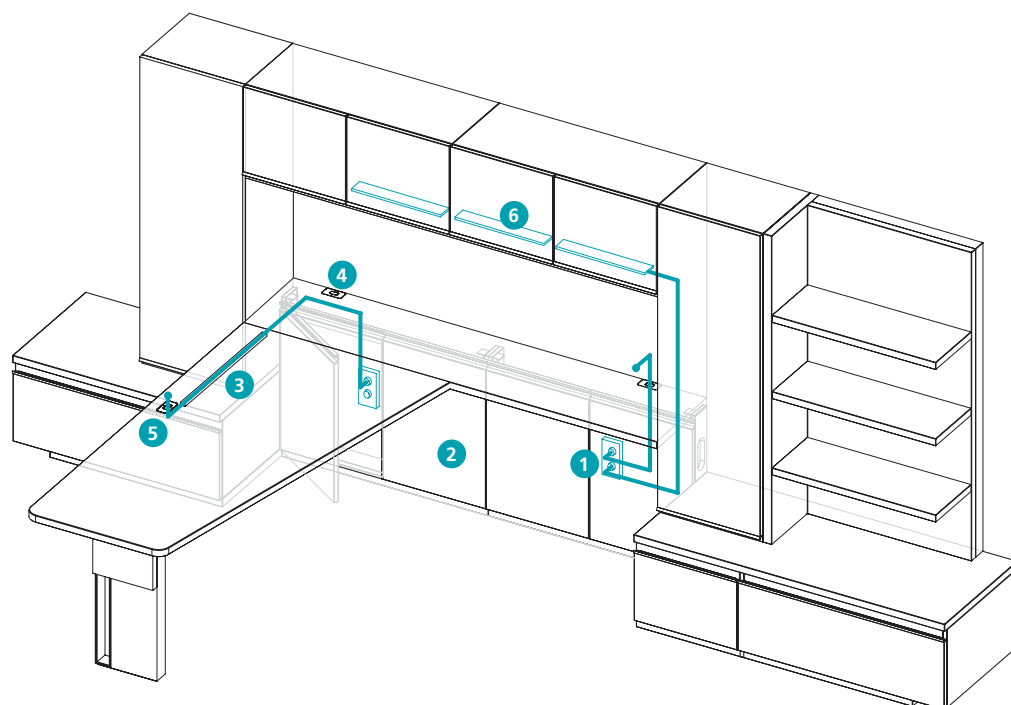
Kneespace Access Panel, full-height

## Technology Accommodation – Casegood Walls

Wire management solutions are integrated on both Apogee wall styles to conceal wires and provide easy access.

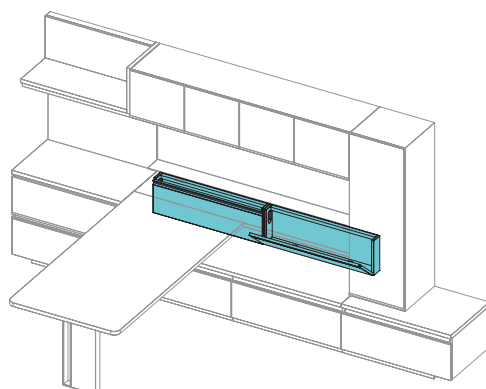
- 1 Building Power Source
- 2 Kneespace Access Panels, full-height
- 3 Wire Management Channel
- 4 Grommets: Workwall Tops
- 5 Grommet: Desks
- 6 LED Task Lights

**Design Tip:** To ensure complete access to building power sources behind full-height Kneespace Access Panels, locate centerline of wall outlets anywhere between 18" to 24" AFF, and center within module width.

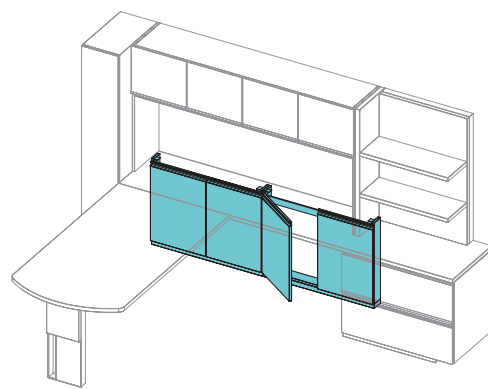


## Kneespace Access Panels

see page 30



Kneespace Access Panel, partial-height



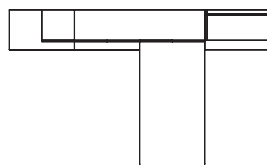
Kneespace Access Panel, full-height

# Design Steps

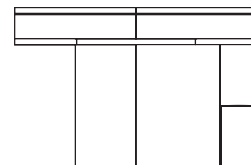
Designing and specifying an Apogee workstation can be easy when you follow these steps.

## STEP 01 Select a Layout

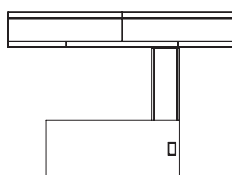
Based upon the user's space and workstyle, start by selecting one of the four Apogee layouts.



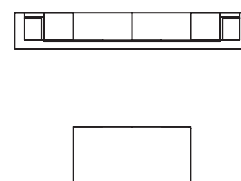
L-Shape Side Workwall (page 08)



U-Shape Side Workwall (page 10)



U-Shape Back Workwall (page 12)



Freestanding Desk Back Workwall (page 14)

## STEP 02 Select either an Architectural Wall or Casegood Wall

If you choose an Architectural Wall, next select:

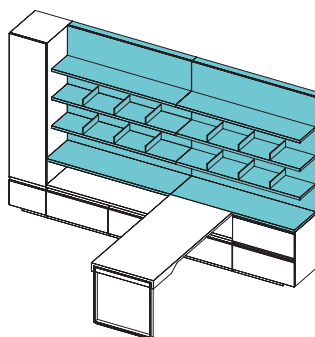
- 1) Open shelves or
- 2) Workcenter Wall:  
Select Workcenter (level 1-6)  
Select End Units

If you choose a Casegood Wall, next select:

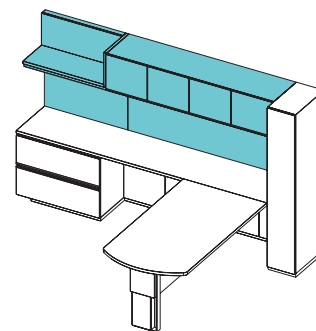
- 1) Wall-mounted overheads & back panel or
- 2) Panel-supported overheads with built-in back panel.

**Design Tip:** Architectural Walls are always wall-mounted to provide a floating appearance.

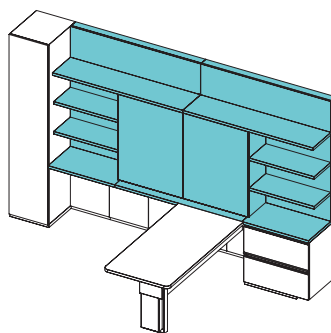
**Design Tip:** Casegood Wall overheads can be wall-mounted creating a floating appearance or freestanding providing easy installation when panel-supported overheads are specified.



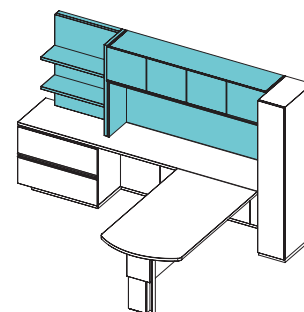
Architectural Wall – Open Shelves (page 17)



Casegood Wall – Wall-mounted Overheads (page 19)



Architectural Wall – Workcenter (page 16)



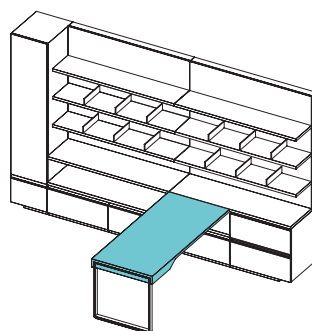
Casegood Wall – Panel-supported Overheads (page 19)

## STEP 03 Select Worksurfaces

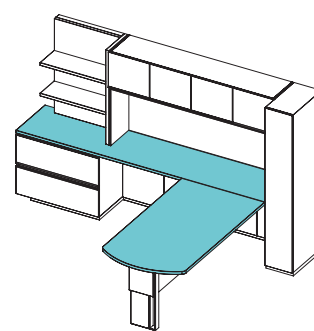
Start by selecting a Desk to fit the layout chosen.

Next, select other worksurfaces such as bridges, returns or workwall tops.

**Design Tip:** Architectural Walls include the 29"H Workwall Tops parallel to the wall plane.



Architectural Wall – Worksurface (page 22)



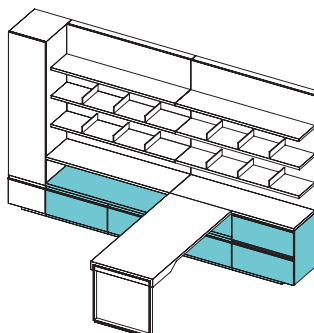
Casegood Wall – Worksurface (page 22)

## STEP 04 Select Low Storage

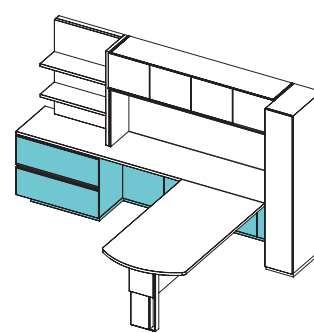
Choose the kneespace and storage combination below the worksurface.

Low Storage components including one-high and two-high lateral files, pedestals, kneespace access panels, and low console connector can be used together or separately.

**Design Tip:** Always pair two-high laterals with a 22"D worksurface top.



Architectural Wall – Low Storage (page 28)

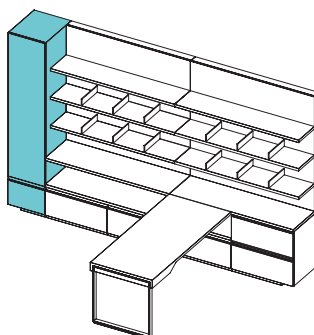


Casegood Wall – Low Storage (page 28)

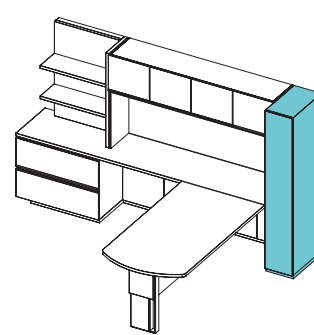
## STEP 05 Select Tall Storage

Add a wardrobe or storage cabinet at the end of the workwall.

**Design Tip:** Tall storage height should match wall height.



Architectural Wall – Tall Storage (page 33)



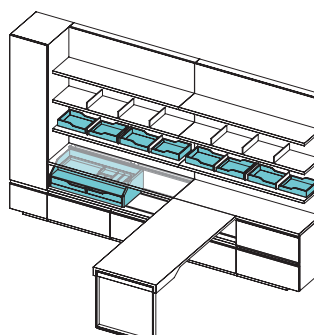
Casegood Wall – Tall Storage (page 33)

## STEP 06 Select Accessories

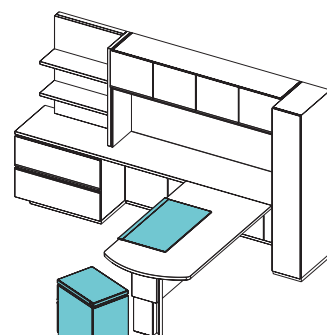
Select materials & finishes.

Add mobile pedestal, shuttle, paper trays or desk pad to complete the specification process.

**Design Tip:** Apogee workflow accessories fit with both Architectural and Casegood Walls.



Architectural Wall – Accessories (page 35)



Casegood Wall – Accessories (page 35)

## Idea Starters

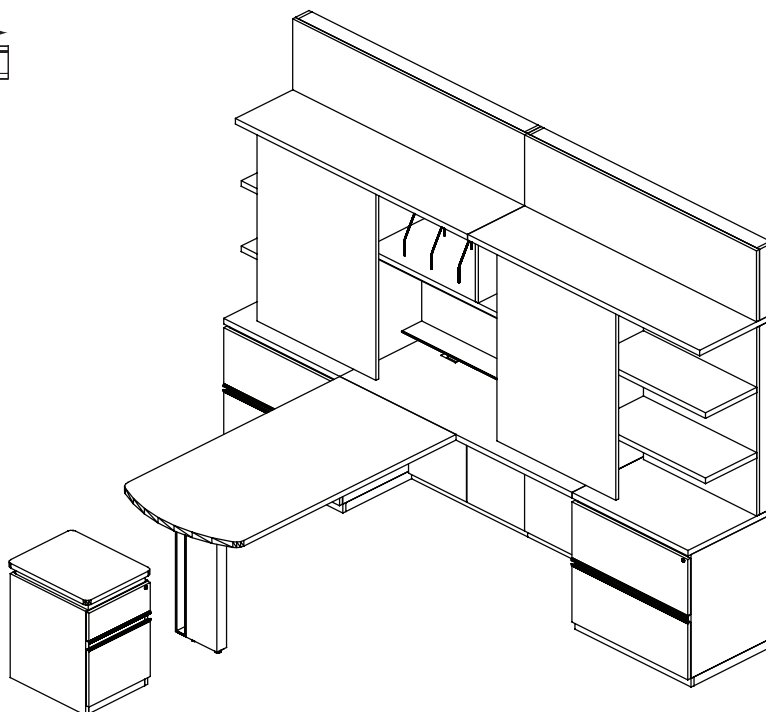
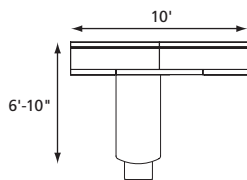
### L-Shape Side Workwall

Apogee L-shape, side workwalls adapt to a variety of spaces and workstyles. Select from the broad offering of components to create large or small footprints with both Architectural and Casework Walls.

The many sizes, shapes and leg styles of Run-off Desks create aesthetic variety while the many combinations of Low Storage optimize space and workflow improving productivity and the work experience.

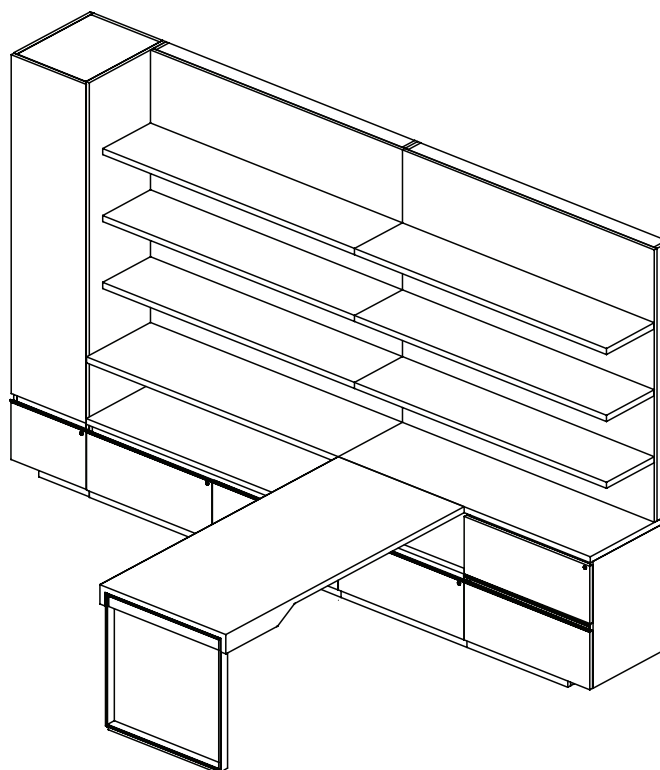
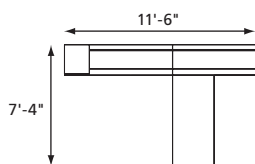
### 01 L-Shape Side Workwall

Architectural Wall, Workcenter



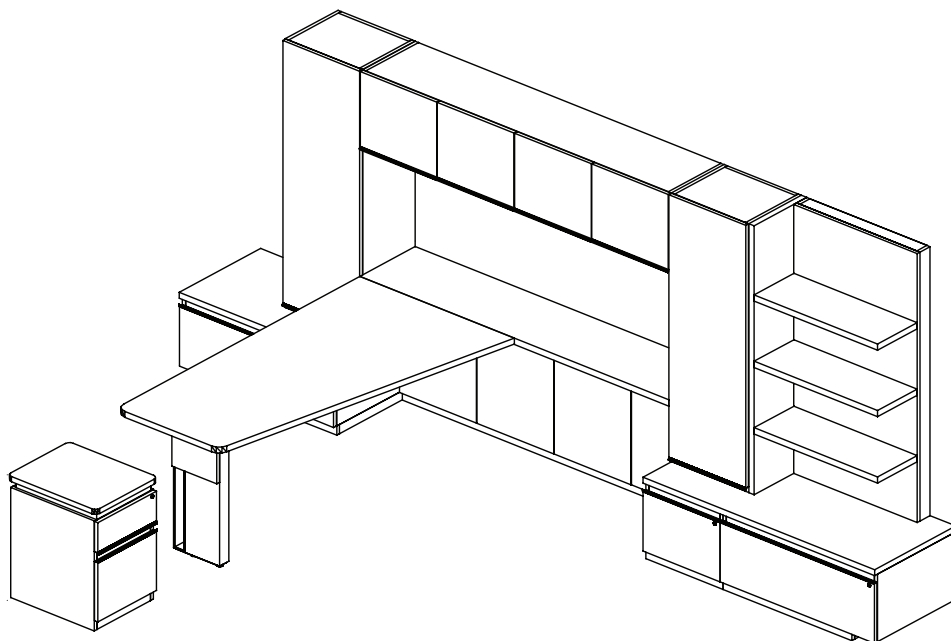
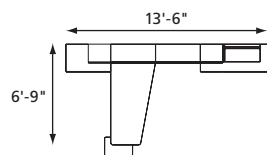
### 02 L-Shape Side Workwall

Architectural Wall, Open Shelves



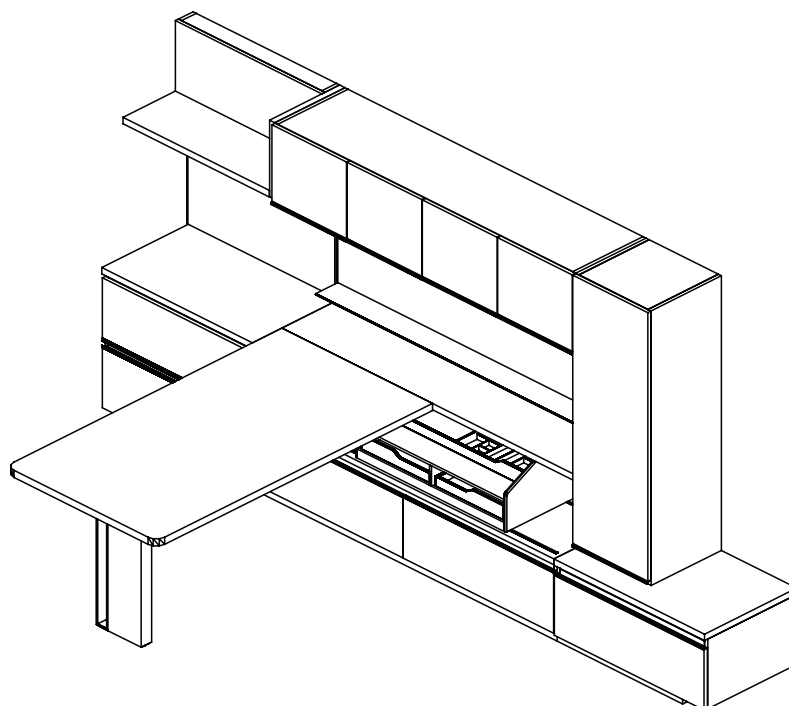
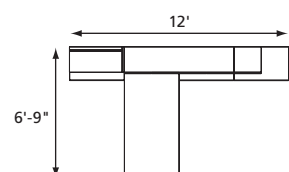
## 03 L-Shape Side Workwall

Casegood Wall



## 04 L-Shape Side Workwall

Casegood Wall



## Idea Starters

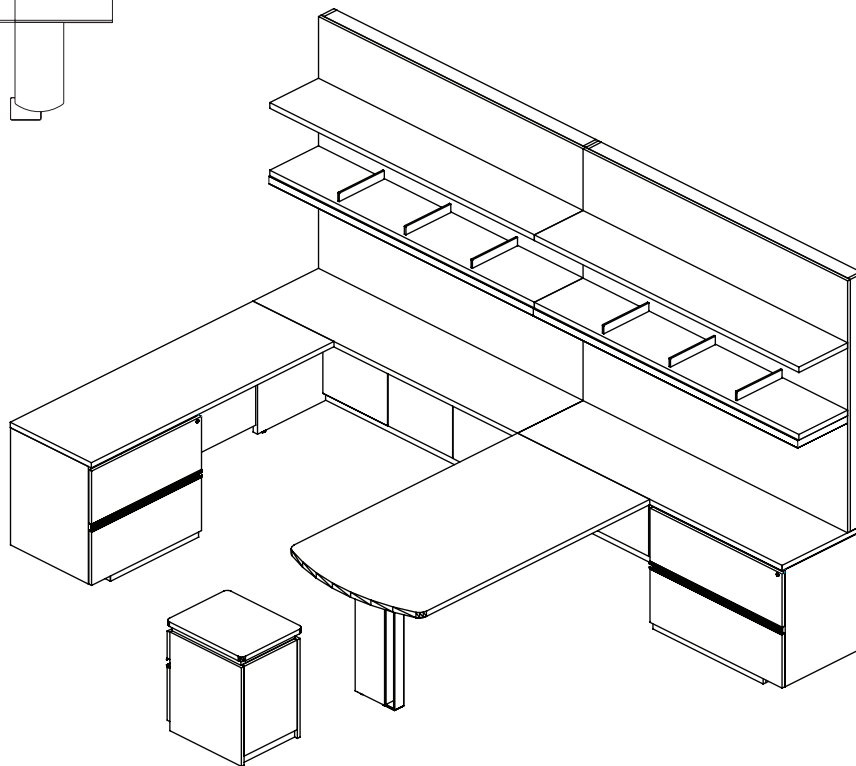
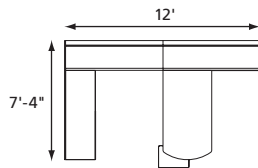
### U-Shape Side Workwall

Apogee U-shape, side workwalls maximize the office footprint with Run-off Credenzas that add extra worksurface and storage. Pair any of these Credenzas with a Casegood or Architectural Wall and a Run-off Desk creating an office tailored to your work style and space.

The Run-off Credenza offering includes a unique one-high lateral unit with a cushion to support impromptu meetings as well as the popular two-high lateral units to maximize filing.

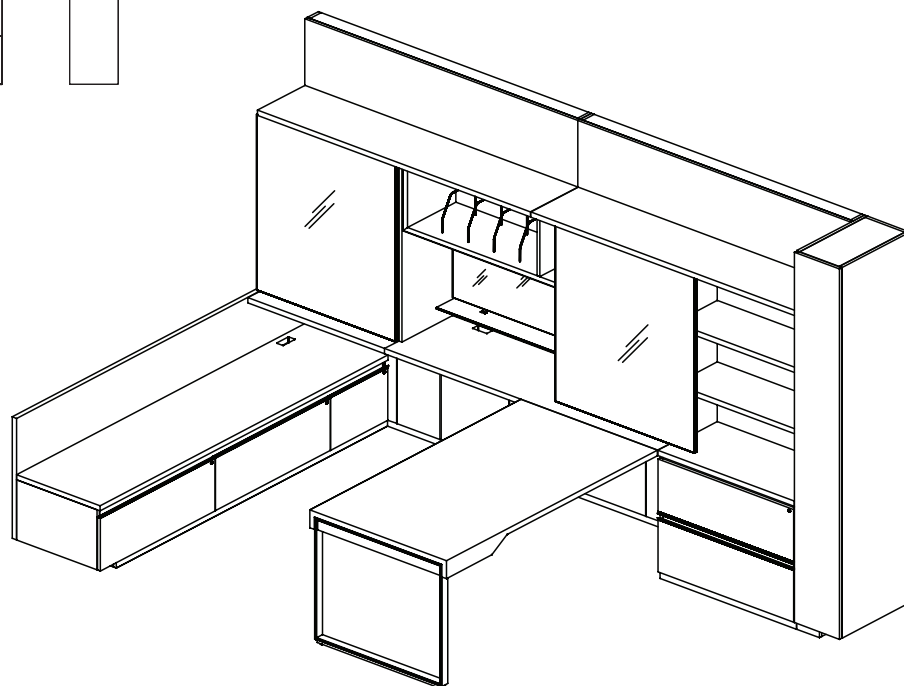
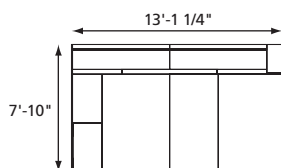
### 05 U-Shape Side Workwall

Architectural Wall, Open Shelves



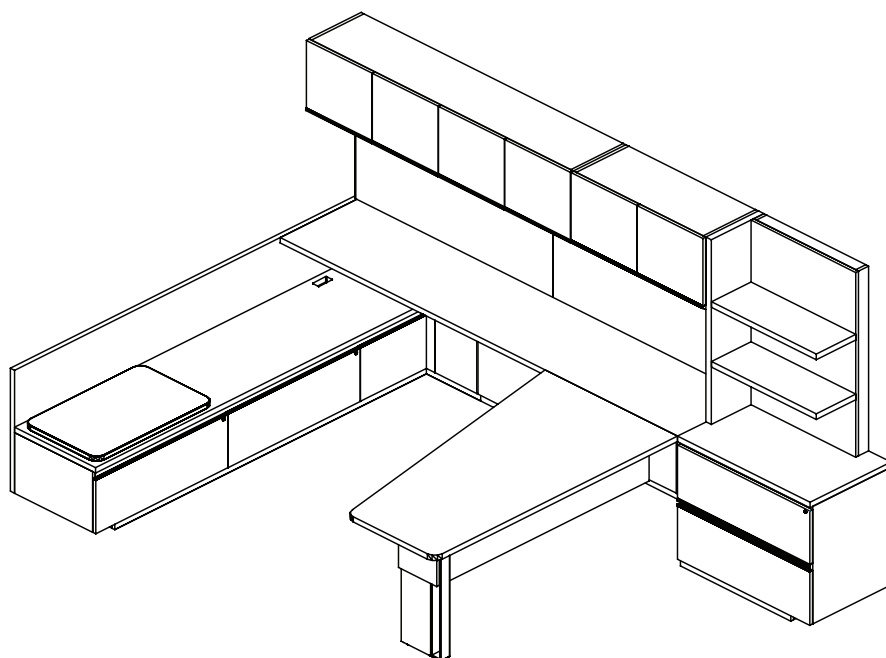
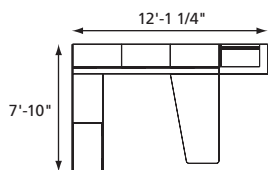
### 06 U-Shape Side Workwall

Architectural Wall, Workcenter



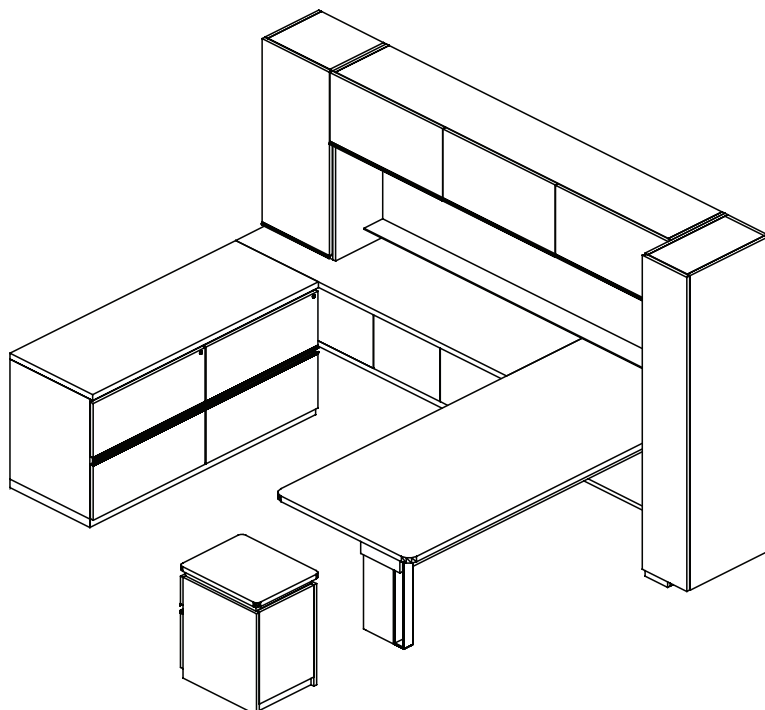
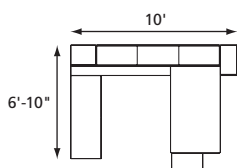
## 07 U-Shape Side Workwall

Casegood Wall



## 08 U-Shape Side Workwall

Casegood Wall



## Idea Starters

### U-Shape Back Workwall

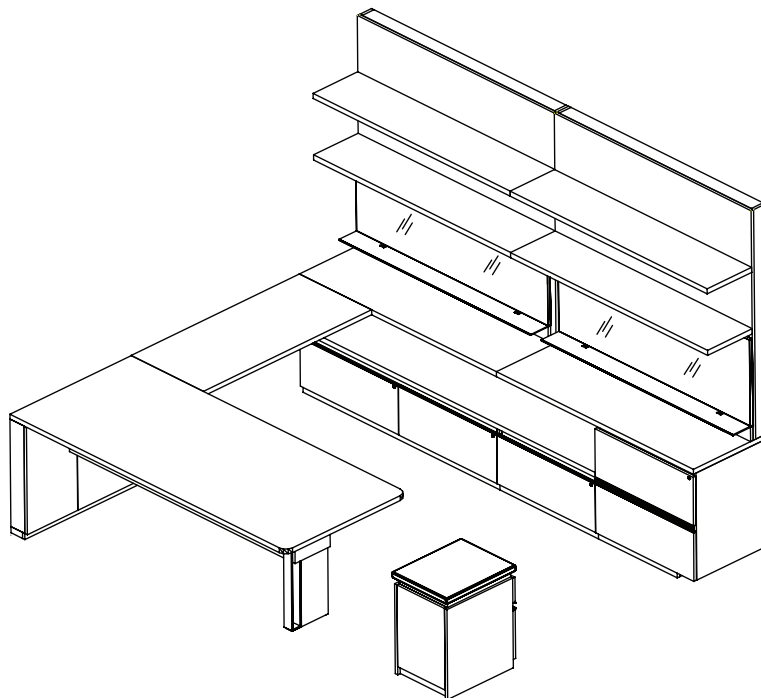
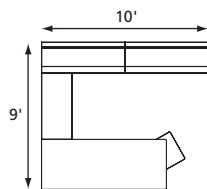
Apogee U-shape, back workwalls feature either a popular Bridge top or an innovative Console unit to connect Desks to Architectural and Casework Walls.

The Bridge top offers a continuous worksurface and kneespace, and should be used with either a Single Pedestal or Panel End Desk.

The Low Console unit aligns and connects with one-high lateral files along the workwall allowing seated access to materials stowed within and atop, and should be used with Table Desks designed to connect with the Low Console.

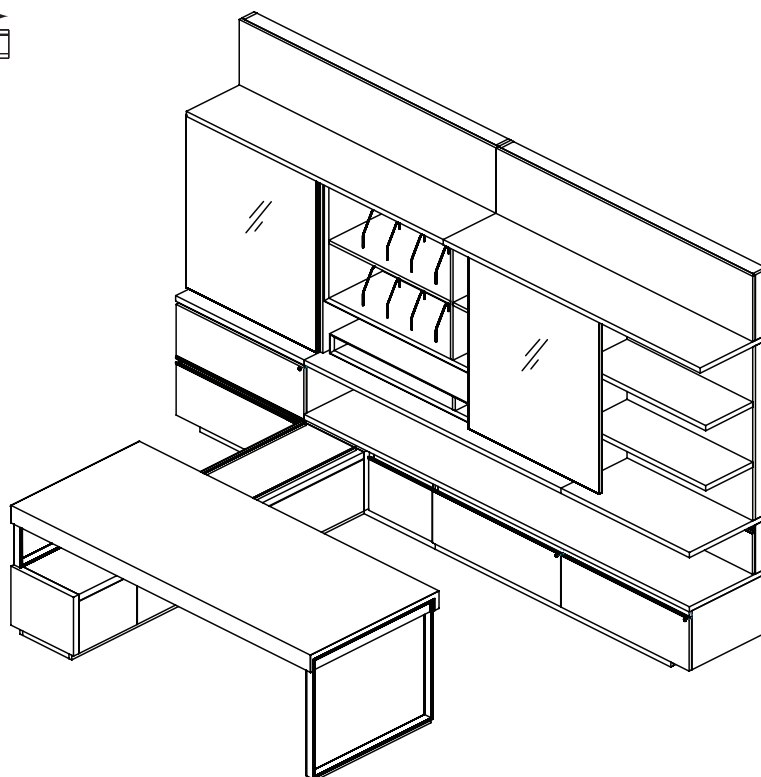
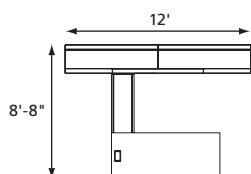
### 09 U-Shape Back Workwall

Architectural Wall, Open Shelves



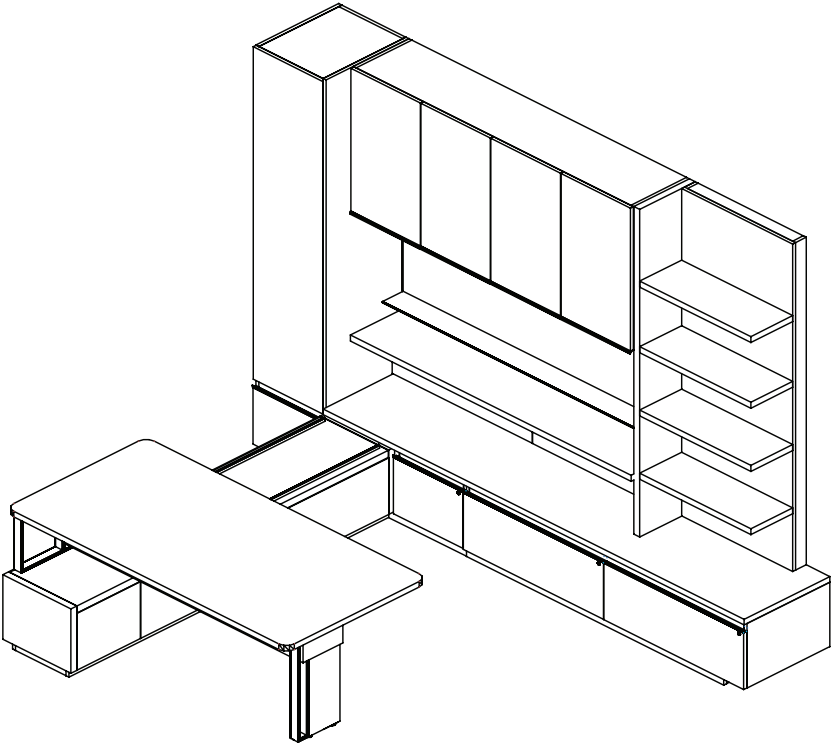
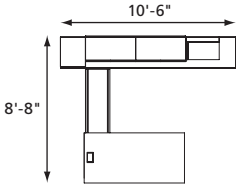
### 10 U-Shape Back Workwall

Architectural Wall, Workcenter



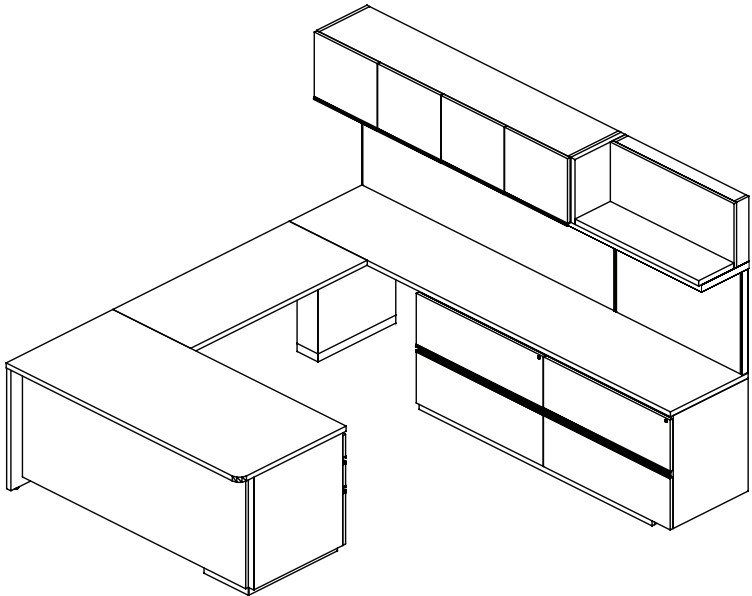
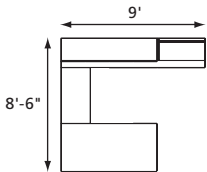
# 11 U-Shape Back Workwall

Casegood Wall



# 12 U-Shape Back Workwall

Casegood Wall



## Idea Starters

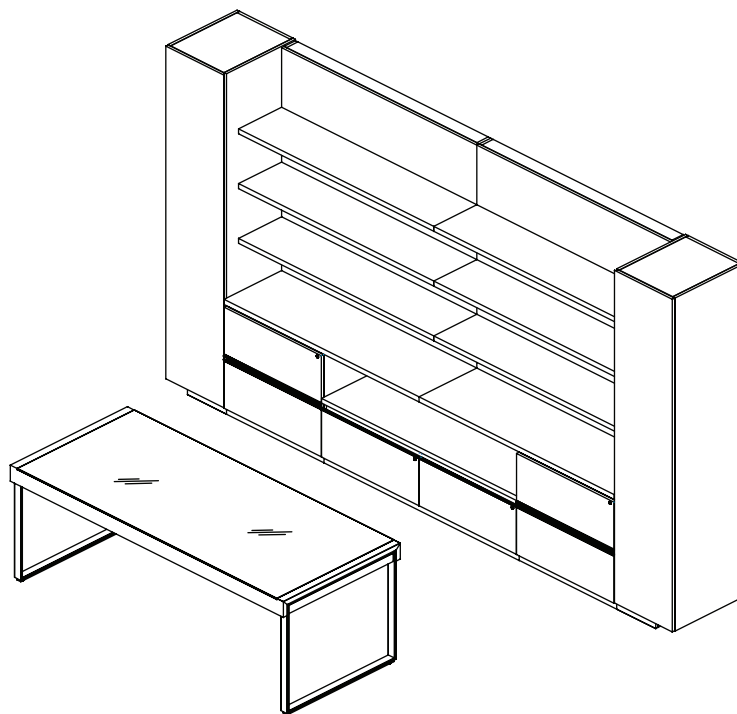
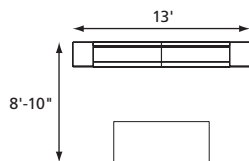
### Freestanding Desk Back Workwall

Apogee's elegant offering of Table and Pedestal Desks are designed to complement both Casegood and Architectural Walls while supporting in-office conferencing and today's technology.

Select from a broad offering of components to create symmetrical or asymmetrical workwalls. One-high and two-high laterals used separately or together with access panels below the worksurface support infinite storage, workstyle and aesthetic possibilities.

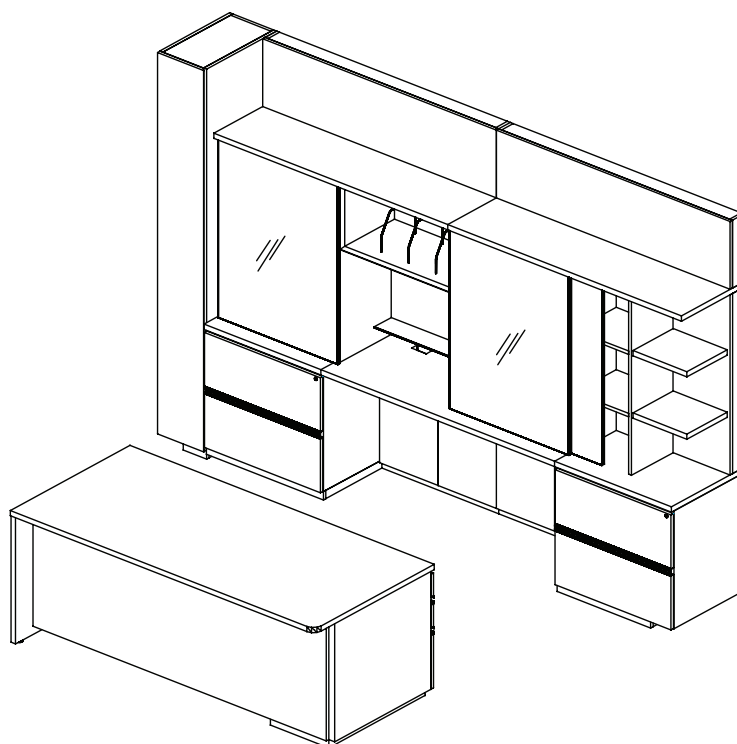
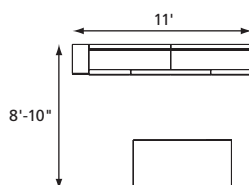
### 13 Freestanding Desk Back Workwall

Architectural Wall, Open Shelves



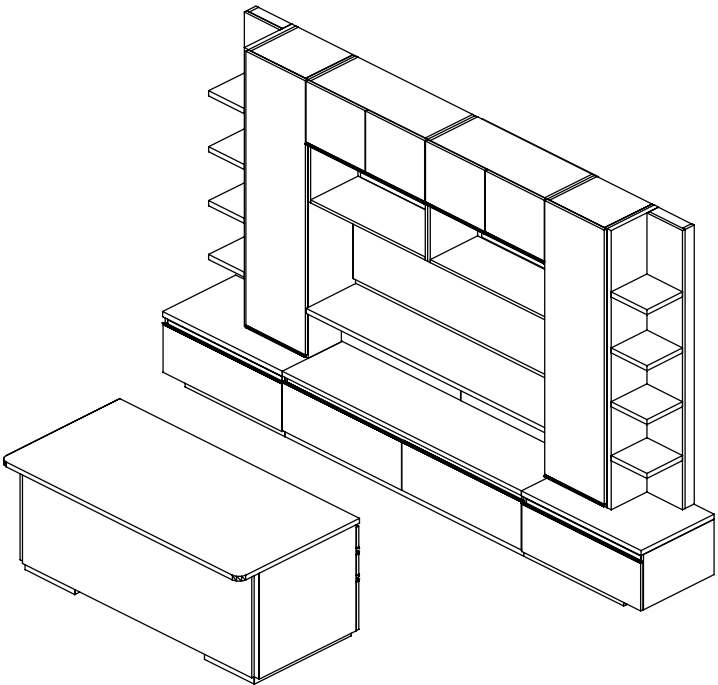
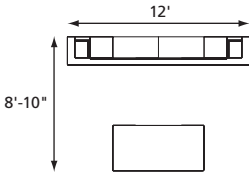
### 14 Freestanding Desk Back Workwall

Architectural Wall, Workcenter



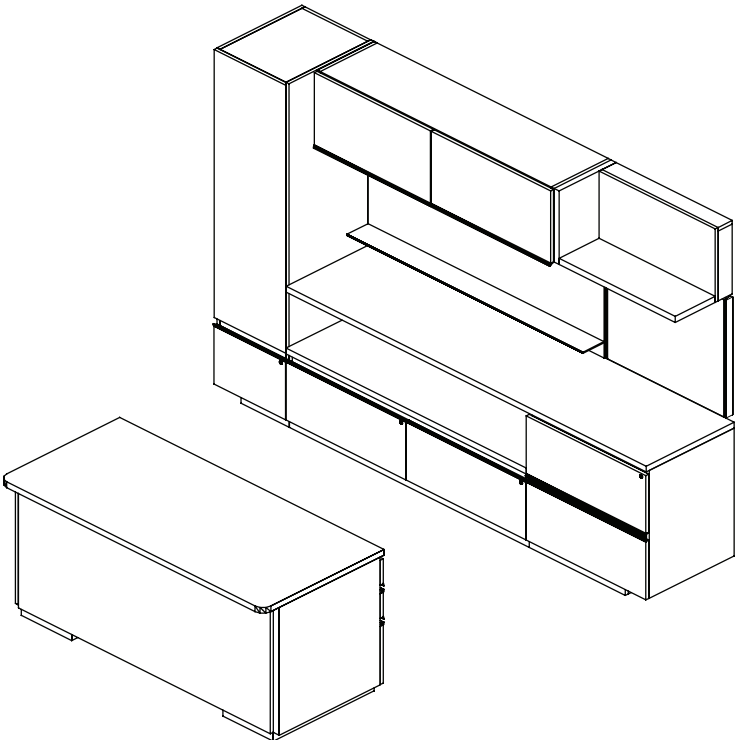
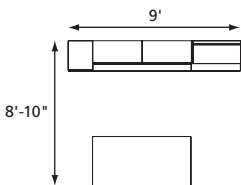
# 15 Freestanding Desk Back Workwall

Casegood Wall



# 16 Freestanding Desk Back Workwall

Casegood Wall



## Planning – Walls

Apogee features an expansive product offering including two distinctive wall types: Architectural and Casegood. Office layouts can be easily customized to fit a user's workstyle and space using these two wall types along with modular or pre-configured desk, credenza, file and storage units.

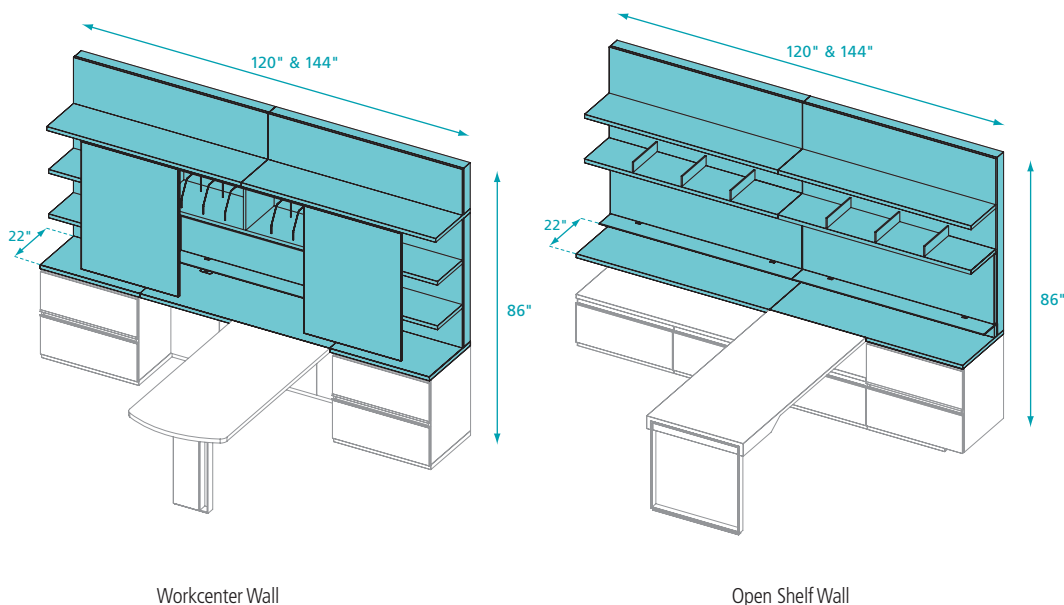
### Architectural Walls

#### Application

Architectural Walls can be specified with Open shelves or Workcenters. Both offerings integrate technology, filing, piling, and reference materials into the private office.

The Architectural Wall components above the worksurface are always wall mounted, and are not common to the Casegood Walls. Architectural Walls are available in two widths – 10' or 12', along with one depth and height – 22" D x 86" H.

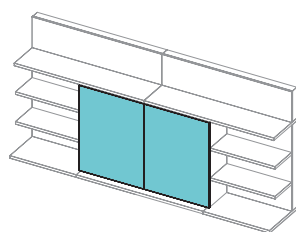
**Design Tip:** Architectural Wall components above the worksurface are a separate offering, and cannot be mixed with Casegood Wall overhead units. Reference Price List for Architectural Wall offering.



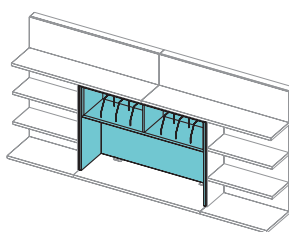
#### Workcenters

Workcenters are positioned in the center of the wall, and flanked by shelving and storage options at each end. Sliding doors enclose contents when not in use. Available in five functional interiors, the Workcenters address a range of workplace activities from technology to storage.

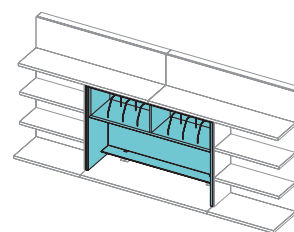
**Design Tip:** Workcenters support both letter and legal depth materials including binders and Redweld file folders.



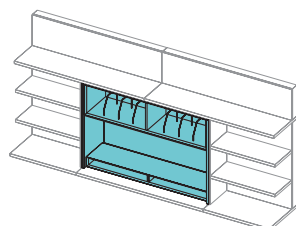
Workcenter with doors closed



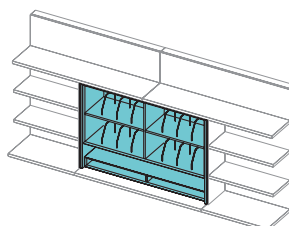
One-high divided overhead



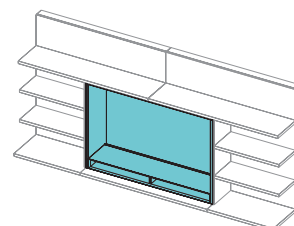
One-high divided overhead & mini-shelf



One-high divided overhead & piling niches



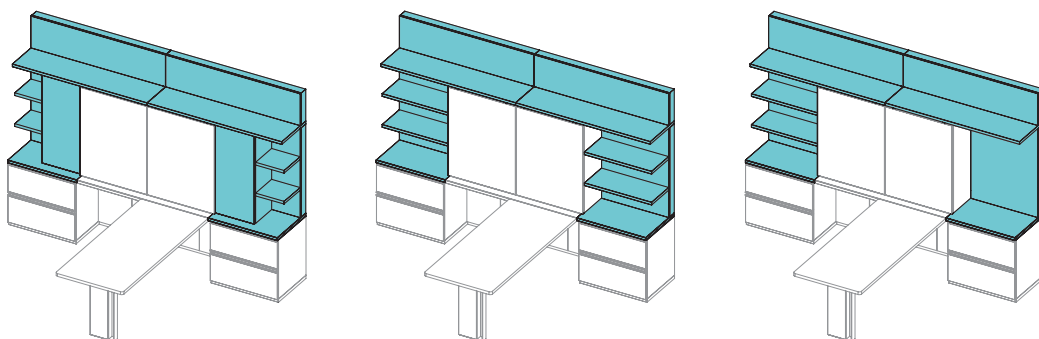
Two-high divided overhead & piling niches



Media wall & technology niches

## Workcenters (cont.)

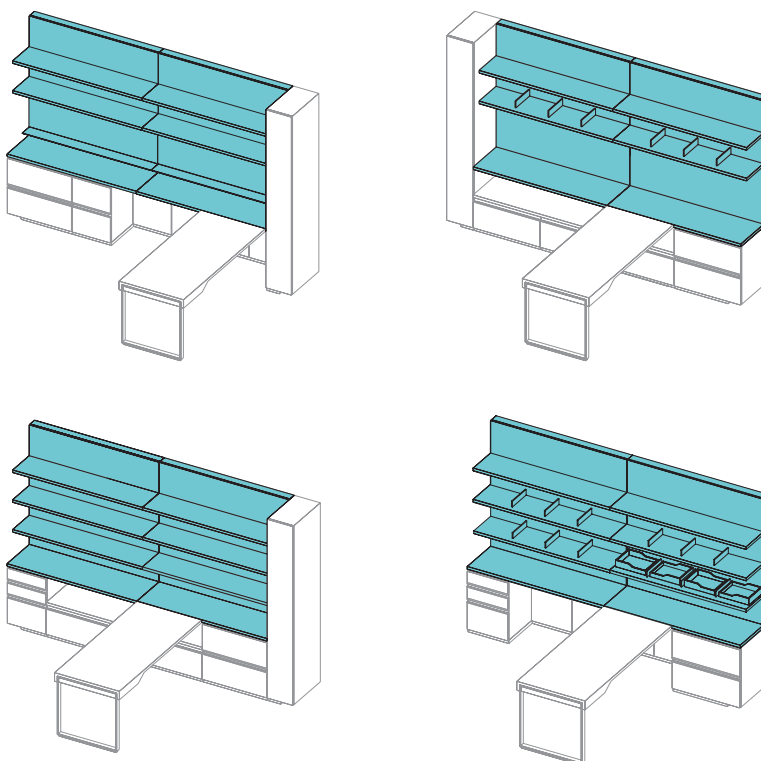
Examples of Ender options shown in symmetrical and asymmetrical configurations:



## Open Shelves

Cantilevered open shelves extend the full length of the Architectural Wall, and can be configured many ways to display technology, piles, reference materials, or artifacts. Open shelves are available with or without divider fins as shown right, and can be specified with letter or legal spacing.

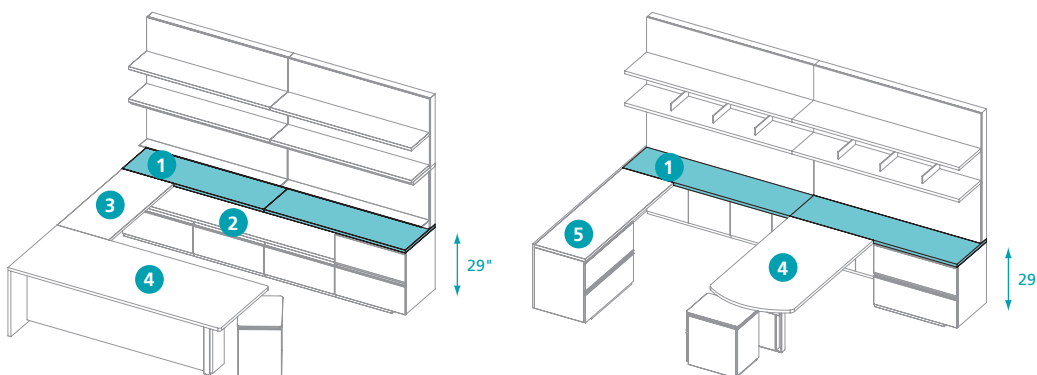
**Design Tip:** When placing Paper Trays between fins on shelves, remember to specify the Paper Tray size to match the divider fin spacing (legal or letter).



## Workwall Tops

Workwall Tops at 29" high along the wall plane are included with the Architectural Wall units, and only desks, bridges and credenzas are specified separately.

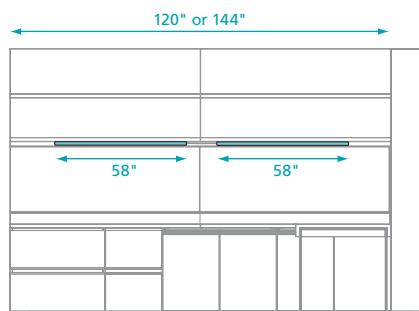
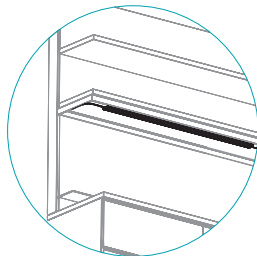
- 1 Workwall Top (included)
- 2 Workwall Top (not included)
- 3 Bridge
- 4 Desk
- 5 Credenza



## Task Lights

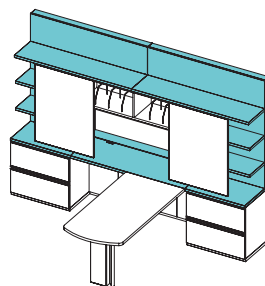
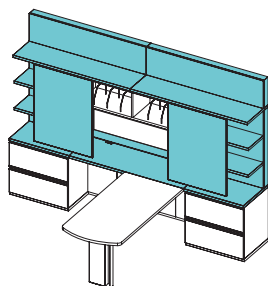
**Workcenters:** LED task lights and valance are standard with single-high overhead storage, and switch on automatically when sliding door is opened.

**Open Shelves:** Optional LED task lights are available on the lower shelf of two-high shelf units only. A continuous, one-piece aluminum valance is recommended when task lights are specified. Both task lights and valances are specified separately, and field installed. We recommend using (2) 58" long task lights for both the 120" and 144" Architectural Walls as shown right. The aluminum valance length should match the wall length.



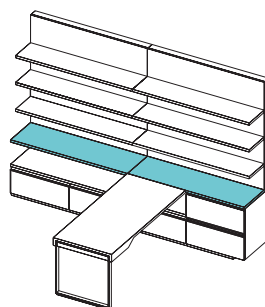
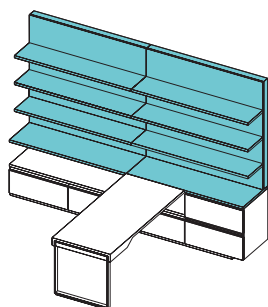
## Finishes + Materials

Architectural Wall components above the Workwall Top can be specified in paint, veneer or a combination of these finishes. Two types of veneer are offered: double-cut (horizontal grain direction) or natural quartered (vertical grain direction). Workwall Tops are included with the Architectural Walls, and are always veneer.

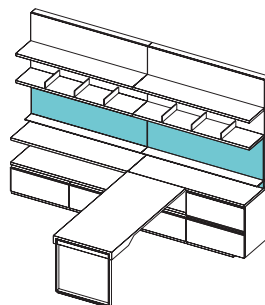
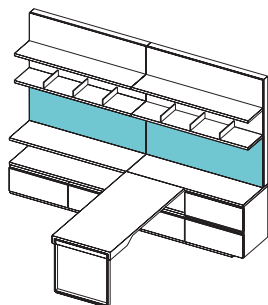


**Workcenters:** The wall plane, shelves and side cabinet are always the same finish, and offered in wood veneer or paint. Workcenter sliding doors are available in veneer, paint or a writeable glass with a magnetic option. Workcenter interiors are always painted except for the back panel which can be specified in paint, veneer, tackable textile or a writeable, magnetic glass.

**Design Tip:** It's important to remember that 29" high Workwall Tops along the wall plane are included with the Architectural Wall, and only desks, bridges and credenzas are specified separately.



**Open Shelves:** The wall plane and shelves are the same finish, and offered in wood veneer or paint. One-high and two-high units offer an optional back in four finishes: paint, veneer, tackable textile or a writeable glass with a magnetic option, and can be specified with or without the anodized aluminum mini-shelf. Optional divider fins on the upper shelves feature an anodized aluminum finish.



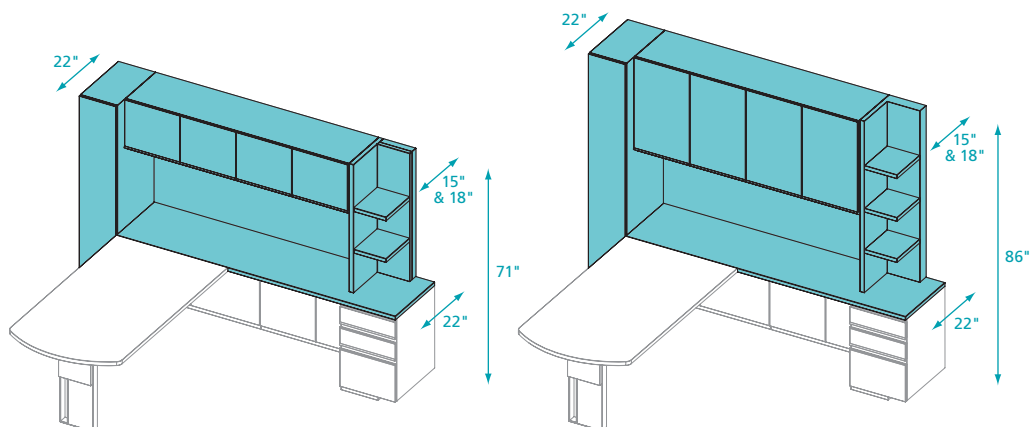
# Casegood Walls

## Application

Casegood Walls feature a creative offering of modular wall components including binder cabinets, asymmetric shelves, back panels and towers which together provide workflow and organizational solutions designed to improve the work experience.

The Casegood Wall components above the worksurface are offered wall mounted or panel supported, and are not common to the Architectural Walls. Both modular and pre-configured units, above and below the worksurface, plan on six-inch increments with flush fit ends.

Casegood Wall components are available in two heights (71" & 86"), and two depths to fit either letter or legal sized materials (15" & 17").

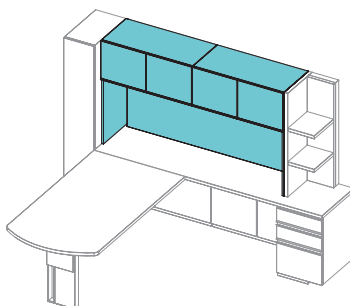


Casegood Wall, one-high overhead

Casegood Wall, two-high overhead

## Overheads, Panel-supported

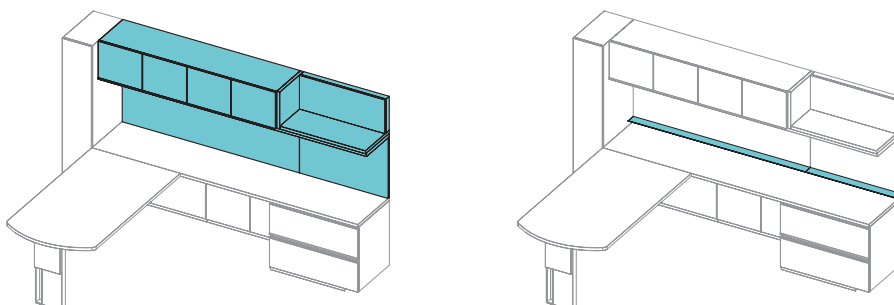
These easy to install overhead units are supported by end panels, and sit atop the worksurface. The overhead units can be specified to fit flush or offset of the Workwall top length. Wall panels are included, and available in four finishes – paint, veneer, tackable textile and a writeable, magnetic glass. A 6" deep mini-shelf option adds another level of organization.



**Design Tip:** Casegood Wall components above the worksurface are a separate offering, and cannot be mixed with Architectural Wall overhead units. Reference Price List for Casegood Wall offering.

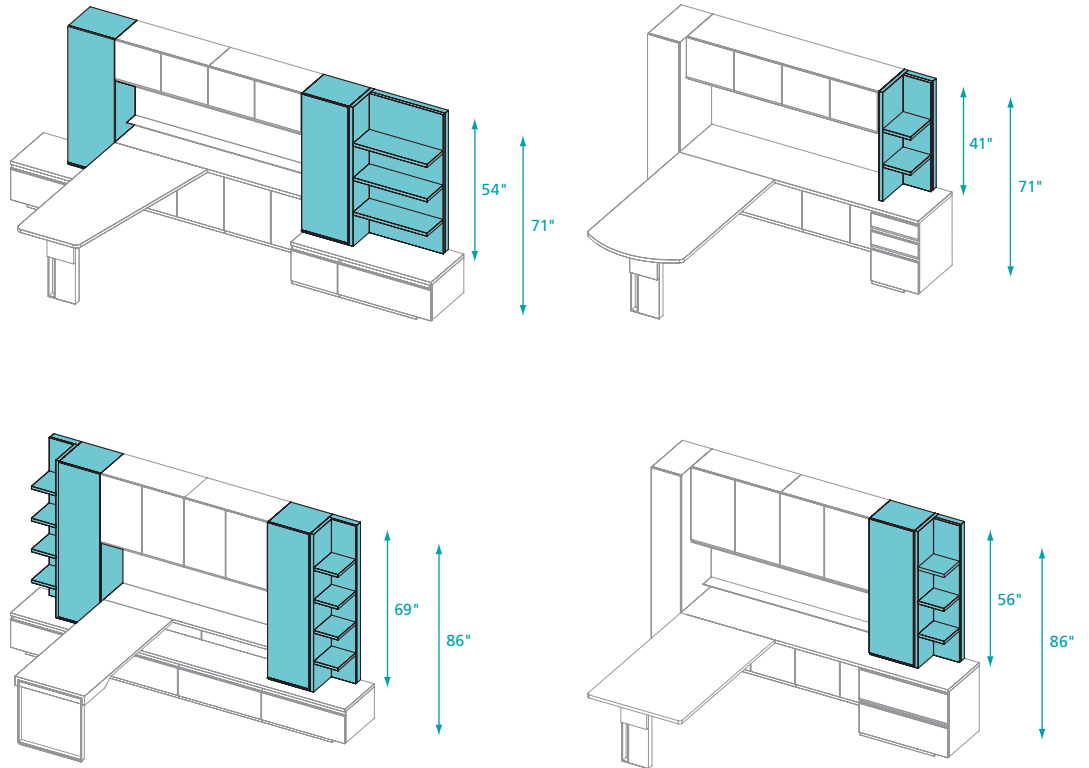
## Overheads, Wall-mounted

Create a minimalist aesthetic and floating appearance with wall-mounted overheads. Always specify Wall Panels with wall-mounted overheads. Wall Panels are available in four finishes – paint, veneer, tackable textile or a writeable glass. An mini-shelf option frees up desk space while keeping small items within reach.

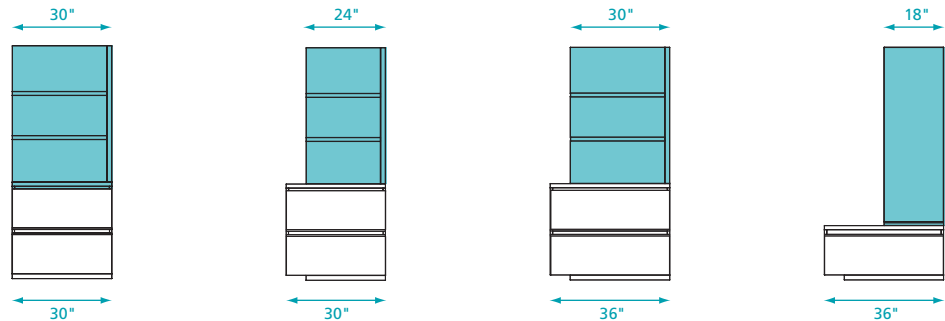


## Towers and Asymmetric Shelves (4 heights)

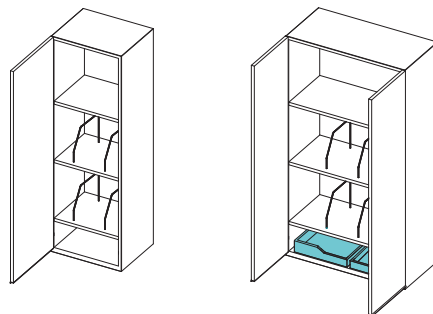
Placed at the end of a workwall, and next to either wall-mounted or panel-supported overheads these units are easy to reach while seated. Available in two depths (letter and legal) and four heights, these units always align with workwall height and can be used atop one-high or two-high laterals. Follow the examples shown right to specify the tower or asymmetric shelf height that fits the workwall and file drawer height combination selected.



**Towers and asymmetric shelves** can be specified to fit flush or inset as shown in examples right.



**Tower units with doors** feature piling niches and file dividers. Specify optional paper trays for added organization.



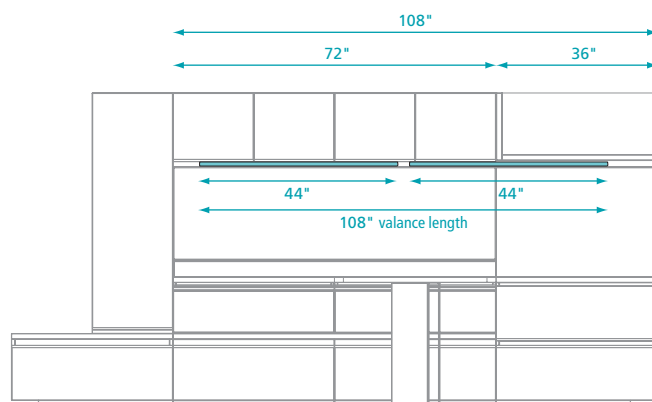
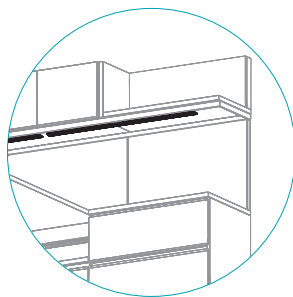
## Task Lights

### Overheads, panel-supported:

Optional LED task lights are easily specified and field installed. An aluminum valance is included with panel-supported overhead units and also field installed.

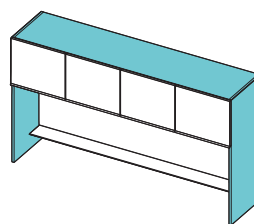
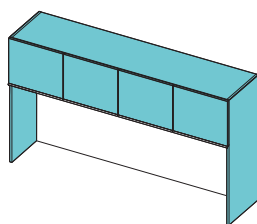
### Overheads, wall-mounted:

LED task lights are specified separately and are available individually in 17, 44 and 58 inch lengths, or as sets in 75 and 88 inch lengths. Specify a combination of task lights that fit the overall length of the overheads. A separately specified aluminum valance, required for structure on all wall-mounted overheads, should match the overall length of the overhead units. See example shown right.

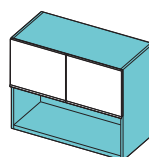
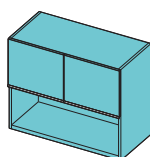


## Finishes + Materials

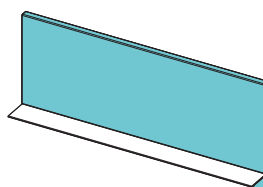
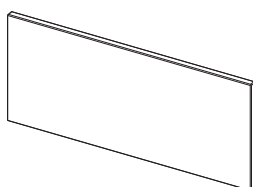
Components above the Workwall Top can be specified in paint, veneer or a combination of these finishes. Two types of veneer are offered: double-cut (horizontal grain direction) or natural quartered (vertical grain direction).



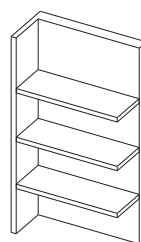
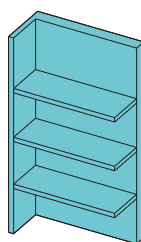
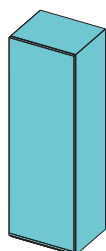
**Overheads, panel-supported:** The overhead units can be specified with matching or contrasting door and chassis finishes. These units feature an integrated door pull and light valance in anodized aluminum. Back panels are offered in four finish options – paint, veneer, tackable textile, or a writeable, magnetic glass, and can be specified with or without the anodized aluminum mini-shelf.



**Overheads, wall-mounted:** The overhead units can be specified with matching or contrasting door and chassis finishes. These units feature an integrated door pull and light valance in anodized aluminum. Back Panels are specified separately.



**Back Panels, wall-mounted:** Back Panels are available with or without the anodized aluminum mini-shelf in four finish options – paint, veneer, tackable textile, or a writeable, magnetic glass.



**Towers & Asymmetric Shelves:** The Tower units can be specified with matching or contrasting door and chassis finishes. These units feature an integrated door pull in anodized aluminum. The Asymmetric Shelf is available in either a painted or veneered finish.

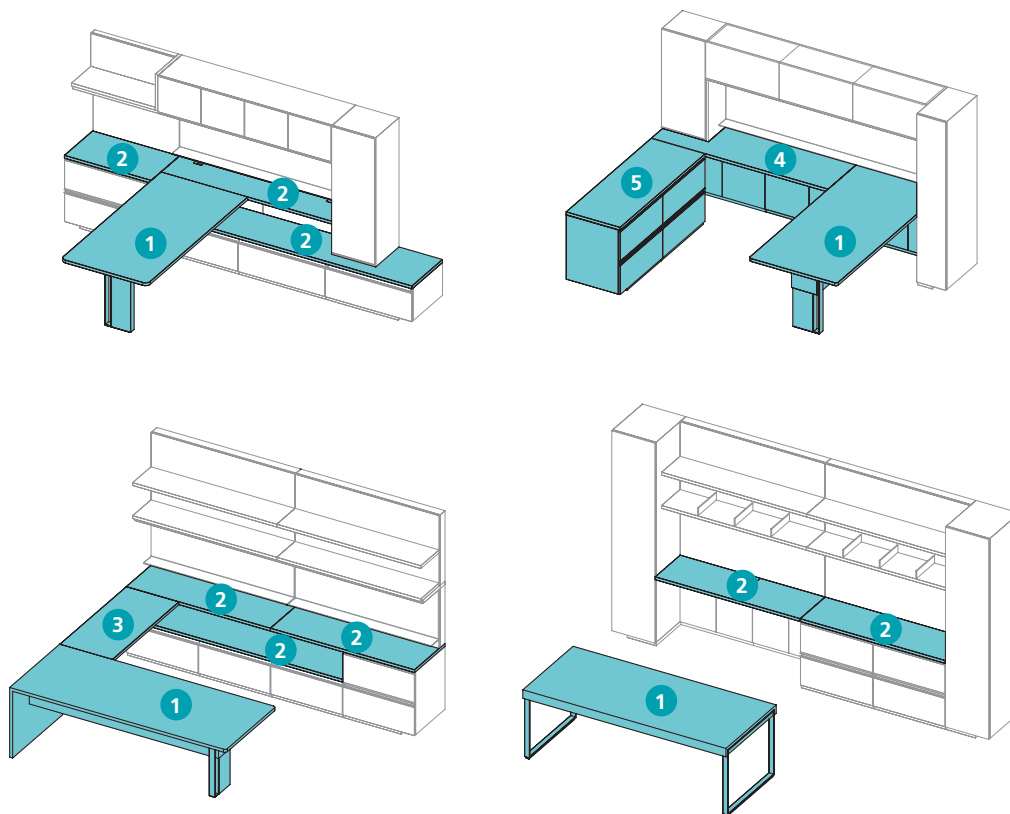
## Planning – Worksurfaces

Apogee's Worksurfaces include all tops and units with a top required to create the various workstation footprints. This includes Desks, Workwall Tops, Bridges, Returns and Credenzas.

### Worksurface Application

- 1 Desk
- 2 Workwall Top
- 3 Bridge
- 4 Return
- 5 Credenza

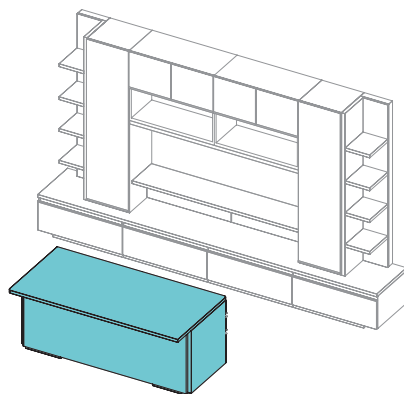
**Design Tip:** Grommets are available on all work surfaces. Reference the Apogee pricelist for locations.



### Desk Application

Apogee Desks are offered in many styles, and provide the primary worksurface for various workstation configurations.

**Double Pedestal and Table Desk:** Designed to work with both Casagood and Architectural Walls, these freestanding desk styles are positioned with back workwalls.



Double Pedestal Desk

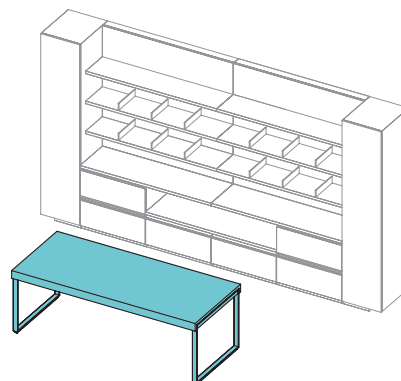


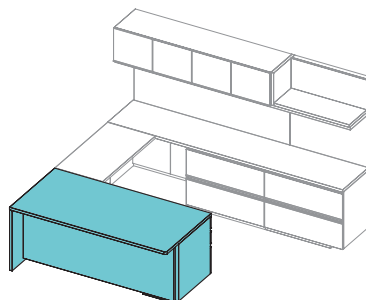
Table Desk

## Desk Application (cont.)

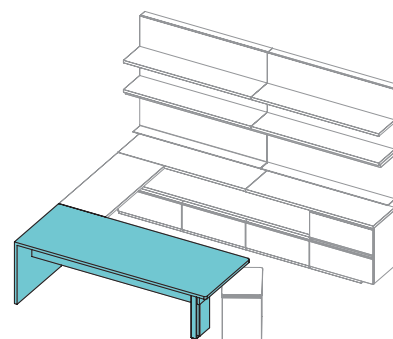
### Single Pedestal and End Panel Desk

**Desk:** Designed for L-shape side workwall and U-shape back workwall layouts with both Architectural and Casework Walls.

**Design Tip:** Pair a Single Pedestal Desk or End panel Desk with other configured units to create easy to specify and install workstations.

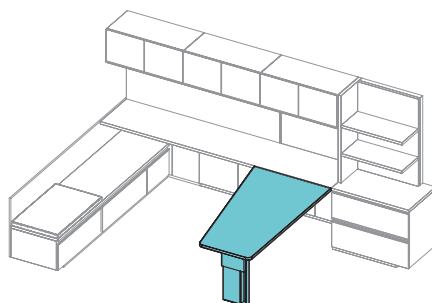


Single Pedestal Desk

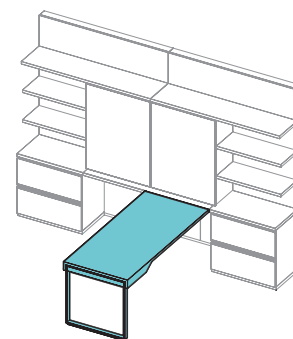


End Panel Desk

**Run-off Desk:** Available in many styles and shapes, the Run-off Desk connects to a Workwall Top, and is used to create L-shape and U-shape side workwall layouts with both Architectural and Casework Walls.



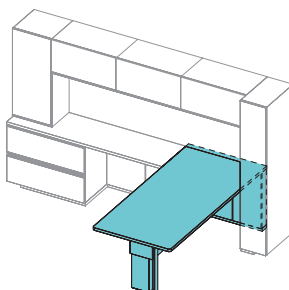
Run-off Desk, Post Support



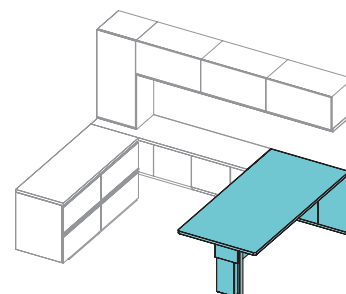
Run-off Desk, Frame Support

**Access End Panel Desk:** Designed for use with Casework Walls only in L-shape and U-shape side workwall layouts. Always pair with Kneespace Access Panels or an Access Panel Return Shell.

**Design Tip:** Access End Panel Desks were designed to create an elegant approach aesthetic, and does not require a tower or file forward of the desk.

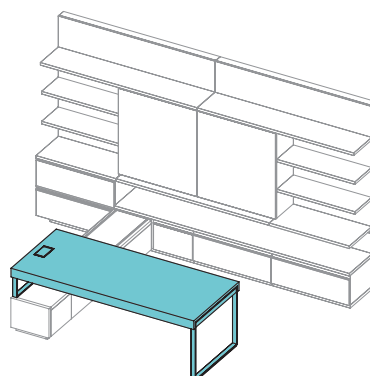


Access End Panel Desk

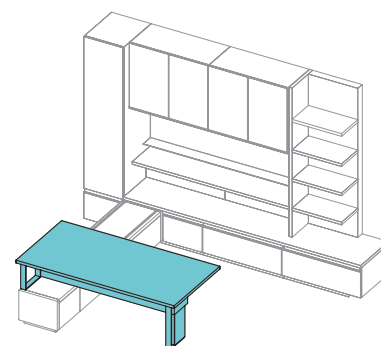


Access End Panel Desk

**Console Desk:** Available in two support styles, the Console Desk must attach to the Low Console, and can be used in U-shape back workwall layouts with both Architectural and Casework Walls or in freestanding applications without a workwall.



Console Desk, Frame Support



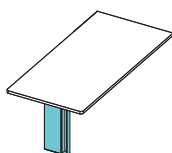
Console Desk, Post Support

## Desk Features and Options

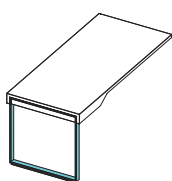
**Desk Support:** Apogee Desks feature three support styles: Post, Open Frame, and Pedestal.

**Desk Modesty Panels:** Modesty Panels offered for each desk support style are shown right.

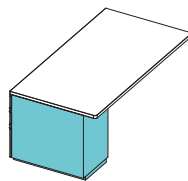
Modesty Panels are optional on Run-off Desks. End Panel Desks (not shown) require a modesty panel for structural stability, and are standard with a partial height modesty panel. See Price List for the full offering of Desk and Modesty Panel options.



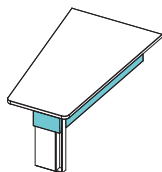
Post Support



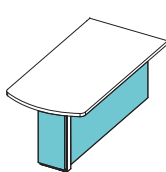
Open Frame Support



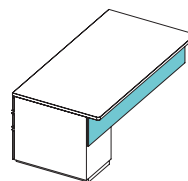
Pedestal Support



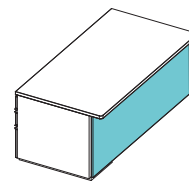
Post, partial-height modesty panel



Post, full-height modesty panel



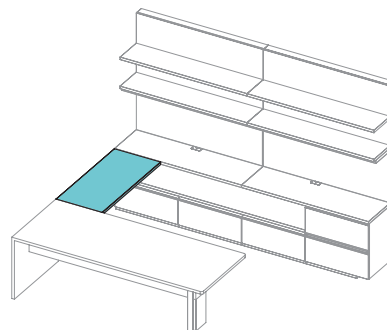
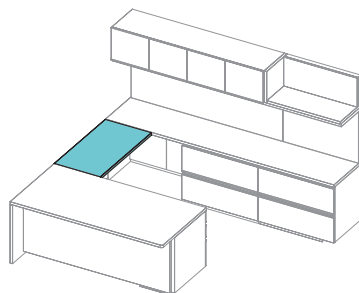
Pedestal, partial-height modesty panel



Pedestal, full-height modesty panel

## Bridge Top Application

Bridge Tops connect Single Pedestal and End Panel Desks to a Workwall Top, and are used in U-shape back workwall layouts. Available in two styles: top only or top and back panel.

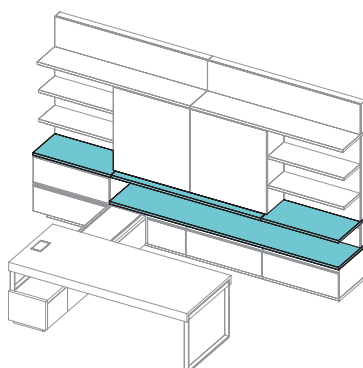
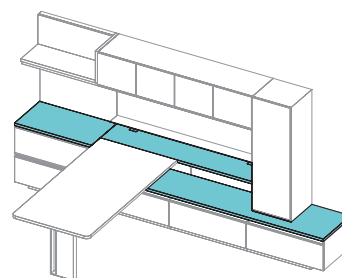
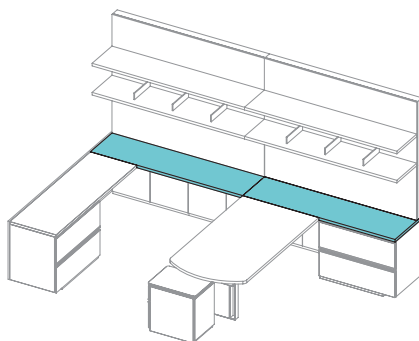


## Workwall Top Application

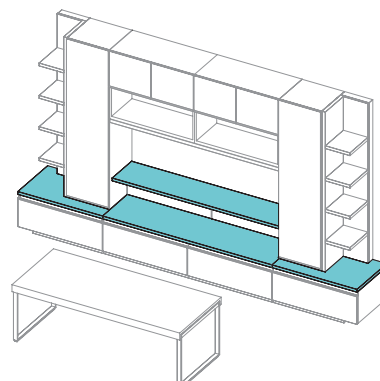
Workwall Tops provide a secondary worksurface, and are used above both full-height and partial-height Kneespace Access Panels, and atop one-high and two-high Pedestals and Lateral Files.

**Architectural Wall** upper modules include a structurally integrated Workwall Top at the 29" high level. These cantilevered Workwall Tops can be specified with or without Lower Storage or Tall Storage support at the end of the workwall.

**Casegood Wall** Workwall Tops are specified separately, and require a Low Storage, Tower or Tall Storage unit at the end of the Workwall Top for support as shown in the examples right.



Architectural Wall



Casegood Wall

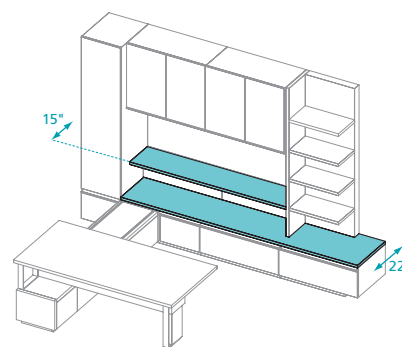
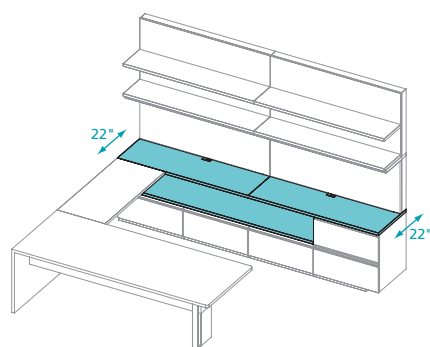
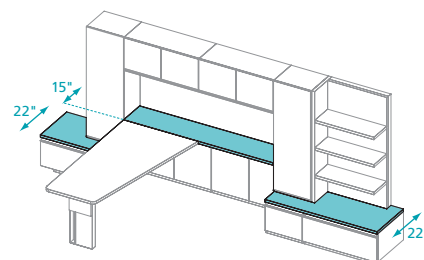
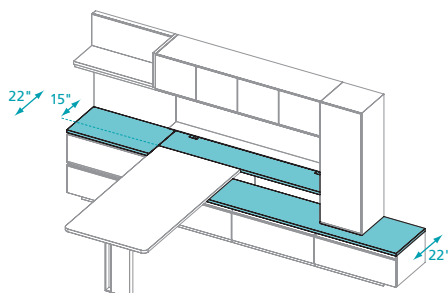
**Design Tip:** To create a floating workwall appearance, always specify the Architectural Wall with the structurally integrated Workwall Top.

## Workwall Top Application (cont.)

Workwall Tops are available in two depths to fit different workstyles and applications as shown right and described below:

- 1) Use a 15" deep Workwall Top above one-high laterals and a 22" deep Workwall Top to create a layered work zone
- 2) Use a 15" deep Workwall Top to fit depth of Towers and Asymmetric Shelves
- 3) Use a 22" deep Workwall Top above two-high laterals or above Kneespace Access Panels
- 4) Use a 22" deep Workwall Top to match depth of Tall Storage

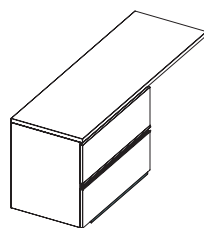
**Design Tip:** The 15" deep Workwall Tops can only be used with Casegood Walls above Kneespace Access Panels at primary worksurface height (29").



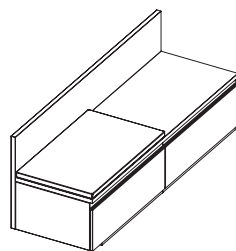
## Run-off Credenza Application

Apogee Run-off Credenzas are used in U shape side workwall layouts, and are offered in two different styles for the applications described below:

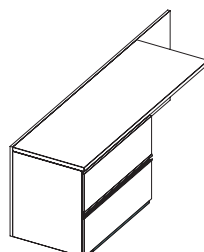
**Return Shell Credenzas** should always be paired with a Return Shell, and these Shells can only be used with Casegood Wall components as shown right.



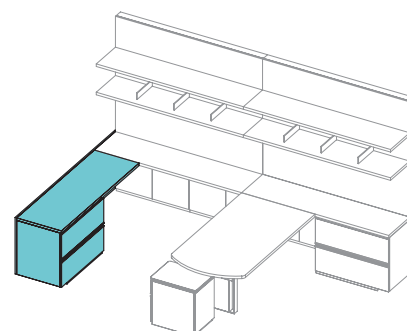
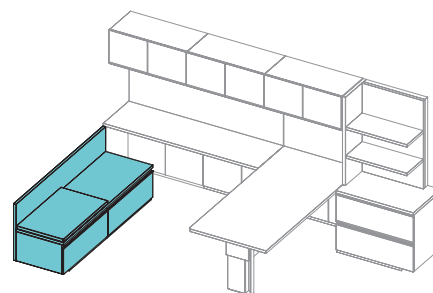
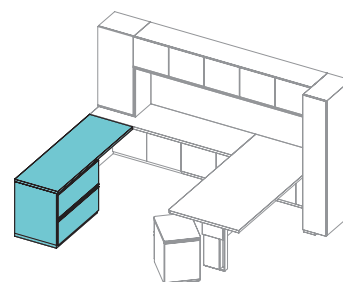
Return Shell Credenza, two-high lateral



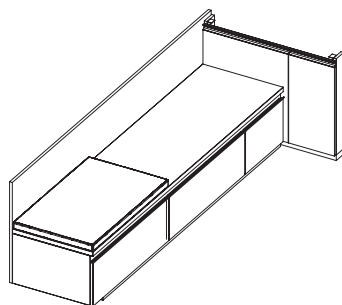
Return Shell Credenza, one-high lateral



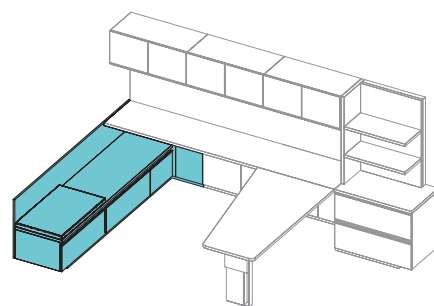
Access Panel Credenza, two-high lateral



## Run-off Credenza Application (cont.)



Access Panel Credenza, one-high lateral with access panel

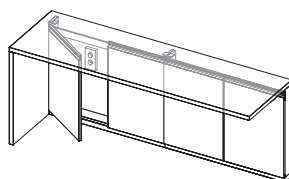


## Return Application

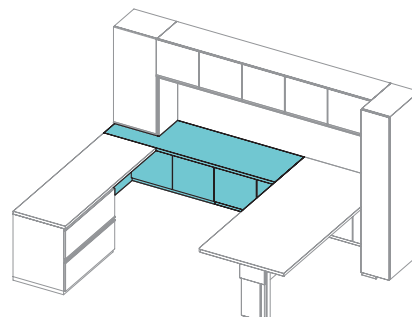
Apogee Returns can only be used with Casegood Walls, and are available in two styles to fit with the desks and applications described below:

### Access Panel, Return Shell

should always be paired with Access End Panel Desks in a U-shape side workwall layout. These returns feature hinged doors in the kneespace allowing easy access to building power.

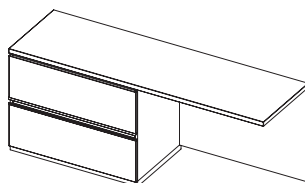


Access Panel, Return Shell

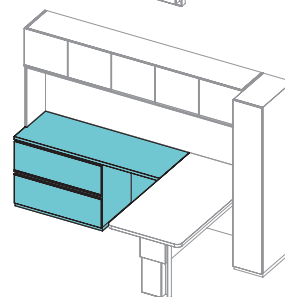


### Fixed Panel, Return Shell and Storage

units should always be paired with End Panel Desks in an L-shape or U-shape side workwall layout. These returns feature pedestal and lateral file options.



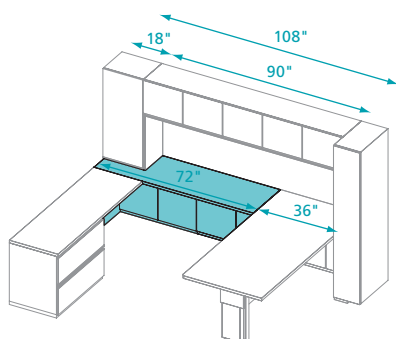
Fixed Panel, Return Storage  
(Shell not shown)



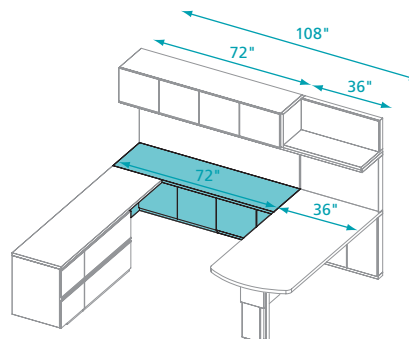
## Return Planning

Both Return styles are available in 6" incremental lengths with offerings that coordinate with desk depths allowing vertical alignment with both panel-supported and wall-mounted overhead offerings as shown in the examples right.

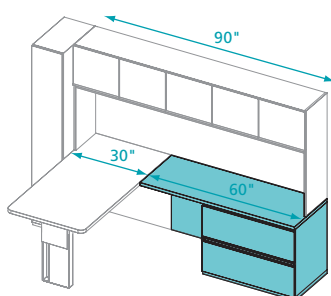
**Design Tip:** Pair these Return styles with coordinating End Panel Desks, Return Shell Credenzas and Panel-supported Overheads for easy to specify and install office solutions.



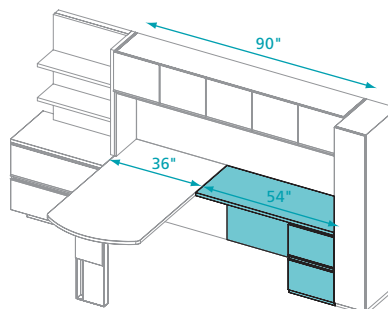
Access Panel, Return Shell



Access Panel, Return Shell



Fixed Panel, Return Storage



Fixed Panel, Return Storage

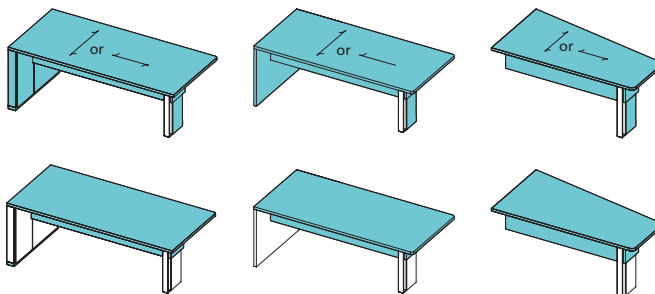
## Finishes + Materials

**Worksurfaces** are always veneer. Post and modesty panels can be specified in paint, veneer or a combination of these finishes. File and pedestal components below the worksurface can be either all paint or all veneer, with a matching or contrasting base finish.

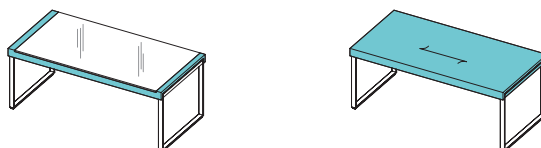
Two types of veneer are offered in a variety of finish colors: double-cut or natural quartered. Grain direction on pedestal, file, modesty and support components below the worksurface is horizontal for double-cut veneers and vertical for natural quartered veneers. The grain direction on worksurfaces is shown right.



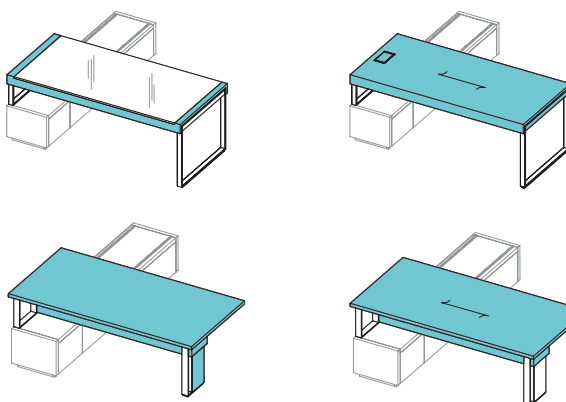
**Double and Single Pedestal Desk** tops are always veneer. Modesty, file and pedestal components below the desk top can be either all paint or all veneer with a matching or contrasting base finish.



**End Panel and Run-off Desk** tops are always veneer, and grain direction can be specified either long grain or short grain. End Panels, post supports, modesty panels, and pedestals can be specified in paint, veneer or a combination of paint and veneer as shown in examples left.

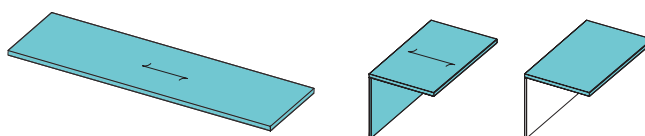


**Table Desk** top is available in long grain veneer or white glass with wood veneer trim. The open frame support is available in a white or silver powder coat finish. The open frame accent apron along the top can be specified in veneer or paint.



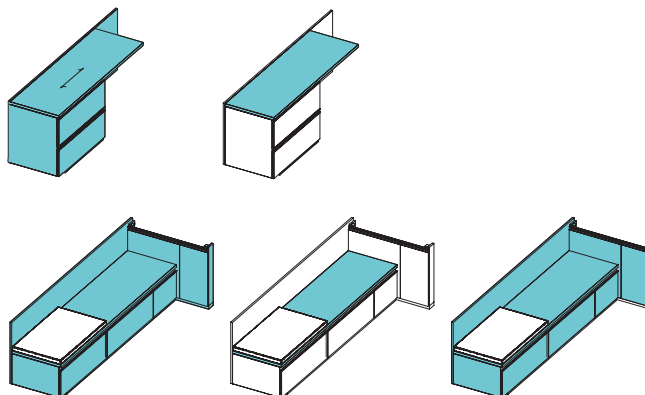
**Console Desk Top** with an open frame support is available in long grain veneer or white glass with wood veneer trim. The open frame support is available in a white or silver powder coat finish. The open frame accent apron along the top can be specified in veneer or paint.

**Console Desk Top** with a post support is available in long grain veneer. The post support and modesty panel can be specified in paint, veneer or a combination of paint and veneer. The metal accent on the post support is available in a white or silver powder coat finish.



**Workwall Tops** are always veneer and long grain.

**Bridge Tops** are always veneer and short grain. Bridge back panels can be specified in paint or veneer.



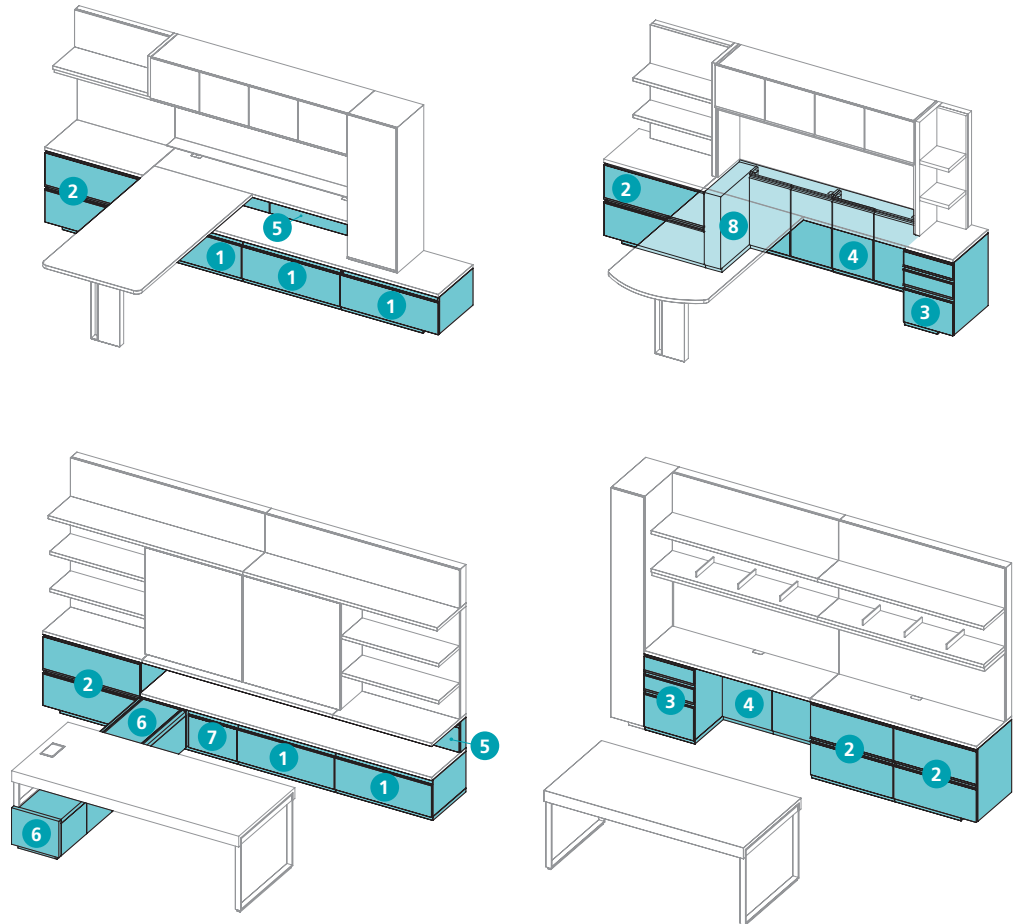
**Credenza** tops are always veneer and long grain. The case and drawer fronts are available in paint or veneer, and the base finish can be specified in paint or veneer to match or contrast the case finish.

## Planning – Low Storage

Apogee's Low Storage components are modular, and consist of one-high and two-high units used below Workwall Tops including Lateral Files, Pedestals, Knesspace Access Panels, Low Console and End Support.

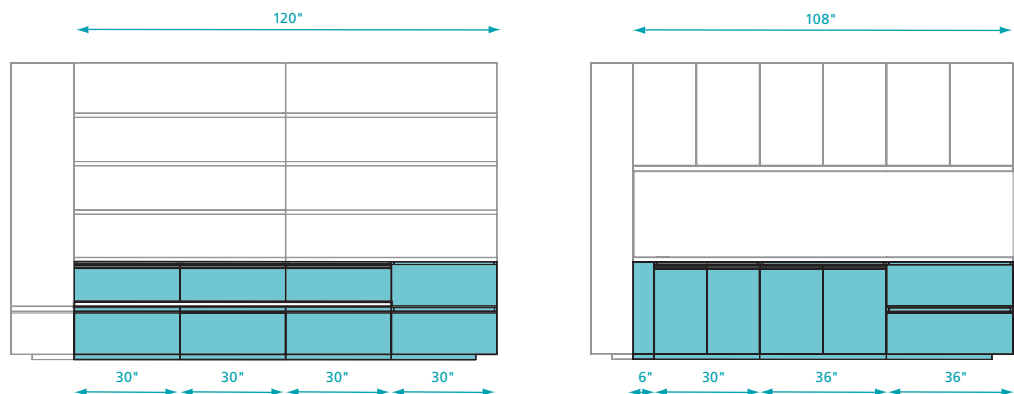
### Low Storage Application

- 1 One-high Lateral
- 2 Two-high Lateral
- 3 Pedestal
- 4 Knesspace Access Panel, full-height
- 5 Knesspace Access Panel, partial-height
- 6 Low Console
- 7 Low Console Connector
- 8 End Support



### Low Storage Planning

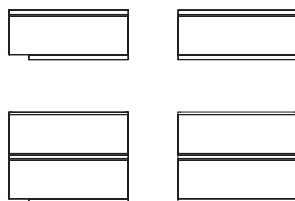
Low Storage components are modular with flush fit ends, and plan on 6" increments as shown in the examples right.



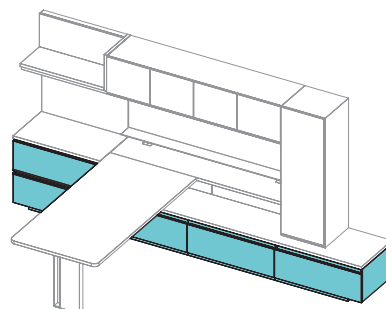
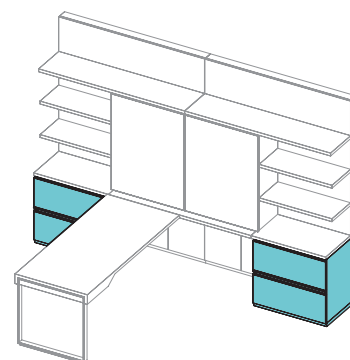
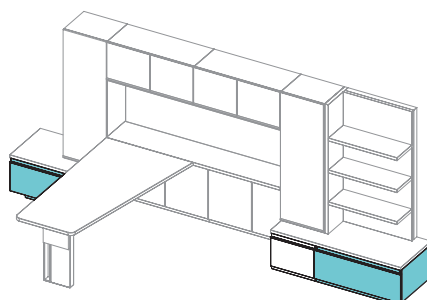
## Lateral File Application

Lateral Files are offered in two drawer heights (one-high and two-high lateral file drawers) along with two widths (30" and 36"). Use one-high and two-high lateral file units separately or together, and combine with Kneespace Access Panels and Workwall Tops as shown right.

**Design Tip:** Pair the inset base with inset Towers and Asymmetric Shelves to accentuate Apogee's architectural aesthetic. See examples page 20.



Lateral File Offering



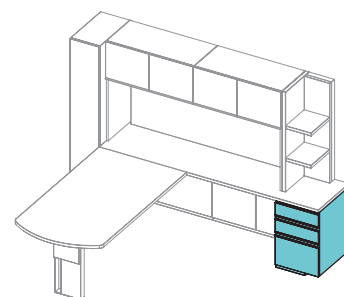
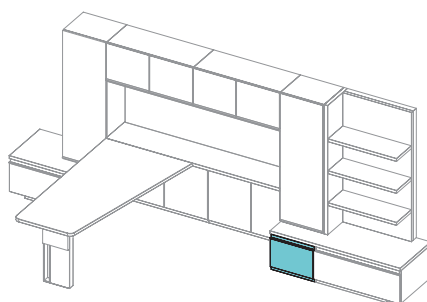
## Pedestal Application

Pedestals are offered in one width, and two drawer configurations – utility/box/file and file/file. The file drawer units are available in one-high and two-high drawer configurations. Use one-high and two-high pedestal units separately or together, and combine with Kneespace Access Panels and Workwall Tops as shown right.

**Design Tip:** For freestanding lateral file or pedestal applications, always specify a flush base.



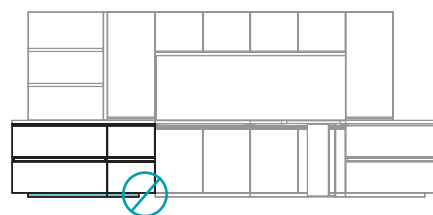
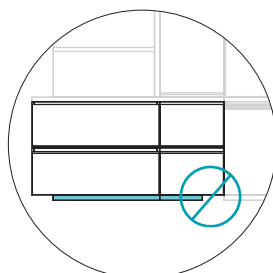
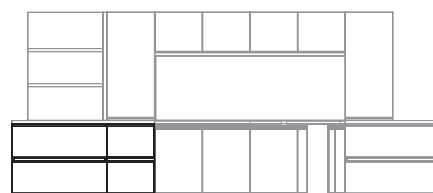
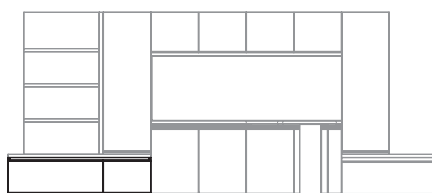
Pedestal Offering



## Lateral File and Pedestal Base Applications

Lateral Files and Pedestals are offered with either a flush base or inset base style. Always specify the flush base for center units and inset base for end units as shown right.

**Design Tip:** To create unhandled workstations, always specify a flush base for Lateral Files and Pedestals.



## Kneespace Access Panel Application

Kneespace Access Panels are offered in 6" incremental widths ranging from 24" to 72", and available in two heights – partial and full. These panels are used below 29" high Workwall Tops, and feature hinged doors that allow easy access to building power and data sources while concealing wires.

**Full-height, Kneespace Access Panels** are used with both Architectural and Casework Walls, and work best in L shape side workwall, U shape side workwall, and freestanding desk back workwall layouts as shown right.

Full-height, Kneespace Access Panels require a separately specified 6" End Support as shown in the L shape side workwall and U shape back workwall right.

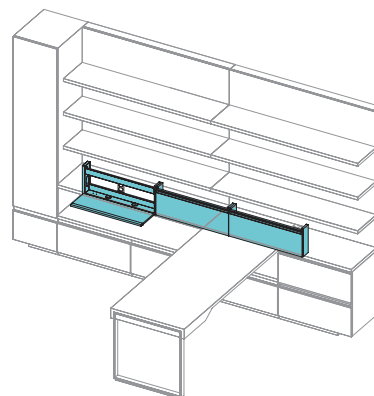
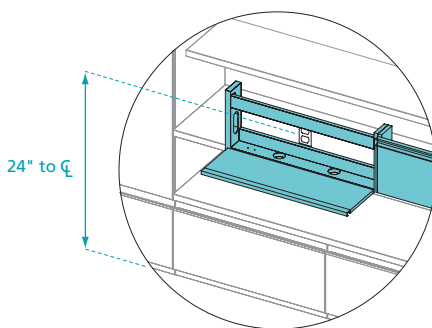
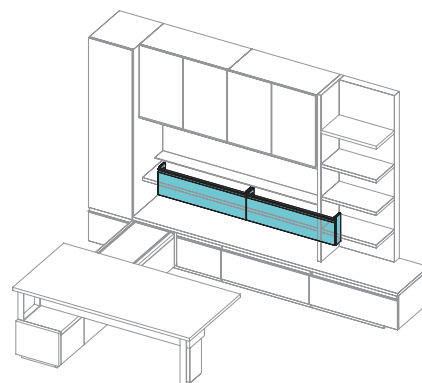
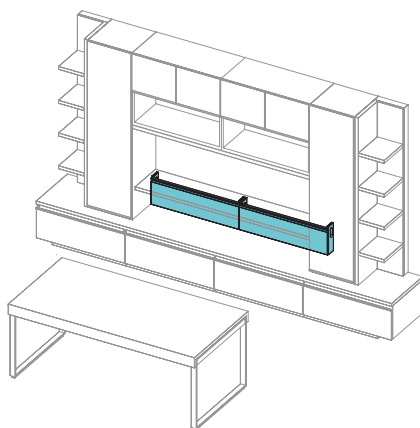
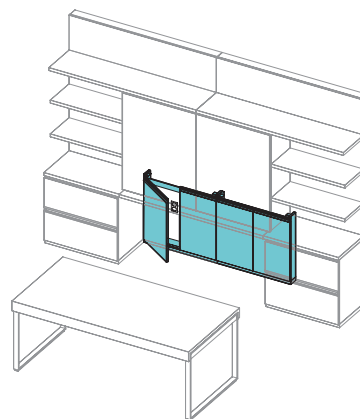
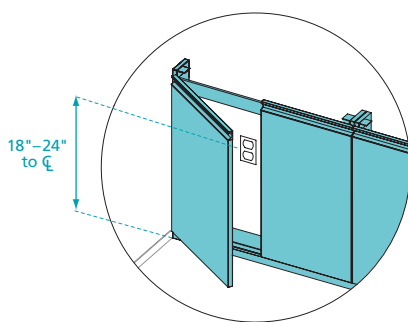
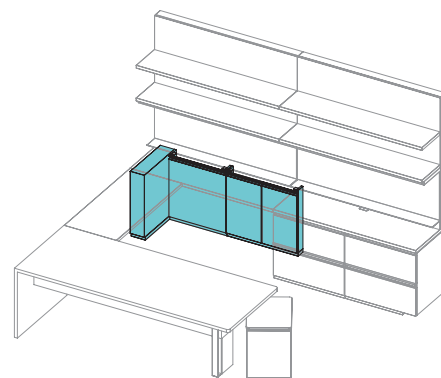
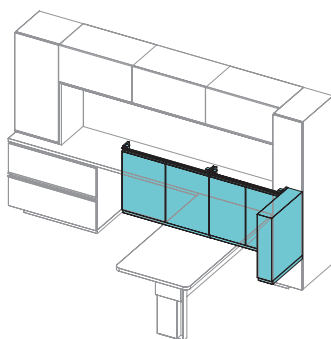
To ensure complete access to building power sources behind Full-height Kneespace Access Panels, always locate centerline of wall outlet between 18"-24" AFF and center outlet within module width as shown right.

**Design Tip:** To easily create a U-shape side workwall with access panels, combine a Return Shell with an Access End Panel Desk and Return Shell Credenza as shown in the Return Shell applications on page 26.

**Partial-height, Kneespace Access Panels** are used with both Architectural and Casework Walls, and work best in L shape side workwall, U shape side workwall, and freestanding desk back workwall layouts as shown right.

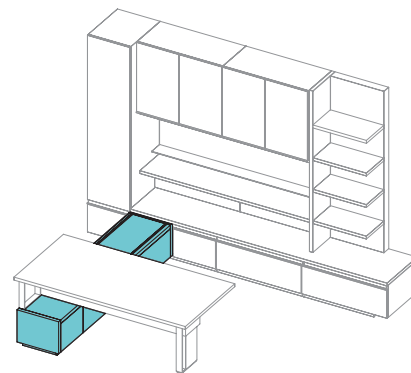
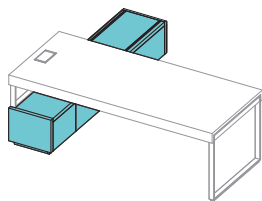
To ensure complete access to building power sources behind Partial-height Kneespace Access Panels, always locate centerline of wall outlet 24" AFF, and center outlet within module width as shown right.

**Design Tip:** Always specify a partial-height Kneespace Access Panel above one-high Lateral and Pedestal Files used below Workwall Tops.



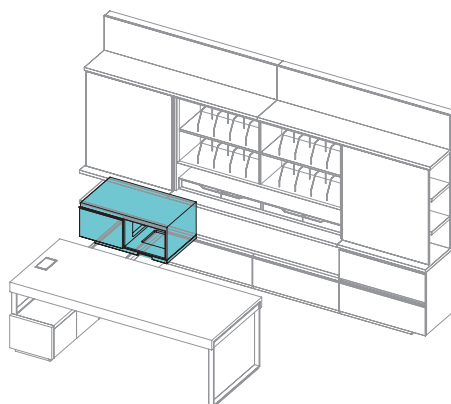
## Low Console Application

The Low Console is always paired with a Console Desk, and can be used in both freestanding and U-shape back wall layouts. Console Desks are supported by the Low Console on one end and a post or frame support opposite. Always specify the Low Console Connector (30" and 36" wide) to join the Low Console to an Architectural or Casework Wall.

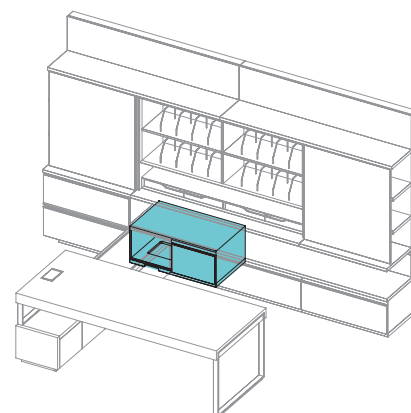


The Low Console Connector is handed, and can be positioned two ways within the back wall as shown right – either aligned or offset.

**Design Tip:** The Low Console can be positioned aligned or offset to the Architectural Wall Workcenter, select the Low Console Connector to suit your layout.



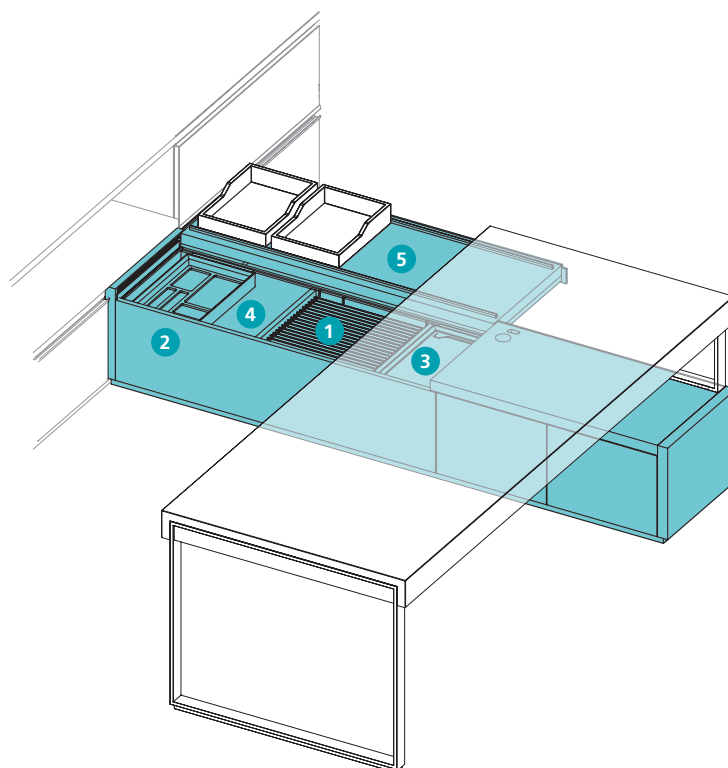
Low Console Connector (left hand),  
shown offset to the Architectural Wall Workcenter



Low Console Connector (right hand),  
shown aligned with the Architectural Wall Workcenter

## Low Console Features

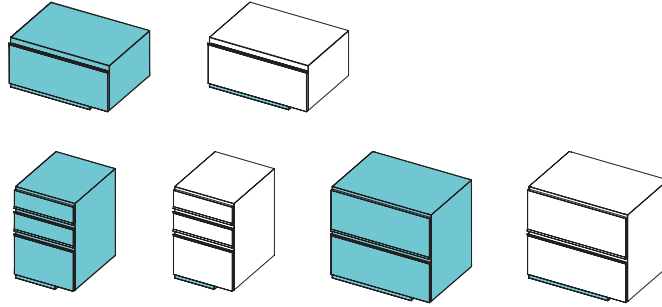
The Low Console supports multi-purpose storage, and features a tray for stowing and charging electronic devices. The console top slides away from the user allowing files and paper to remain in place while open. The Low Console also provides a wire management path from the Desk to the Low Console Connector within the Casework or Architectural Wall (see Technology Accommodation page 04).



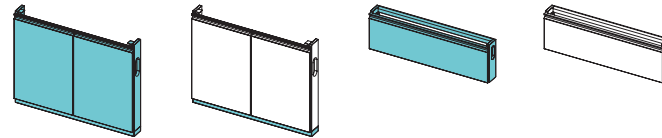
- 1 Letter or Legal Filing**
- 2 Accessories Tray**
- 3 Charging Tray**
- 4 Storage Space Below**
- 5 Sliding Top with Paper Tray Rails/Pulls**

## Finishes and Materials

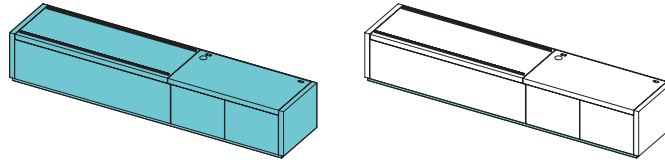
Low Storage units are modular to support matching or contrasting finish combinations. Two types of veneer are offered: double-cut or natural quartered in a variety of finish colors. Grain direction on Low Storage is horizontal for double-cut veneers and vertical for natural quartered veneers.



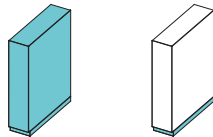
**Lateral File and Pedestal** units are offered in either all paint or all veneer, except the base which can be specified in paint or veneer to match or contrast the unit. Drawers feature an integrated anodized aluminum pull.



**Kneespace Access Panels** are offered in either all paint or all veneer, except the base which can be specified in paint or veneer to match or contrast the unit. The access doors feature an integrated, anodized aluminum pull.



**Low Console** units are offered in all paint or all veneer, except the base which can be specified in paint or veneer to match or contrast the unit. The aluminum pulls/rails along the top feature a silver powder coat. The solid wood accessory and charging trays are available in a variety of paint colors, and feature felt liners in a charcoal color.



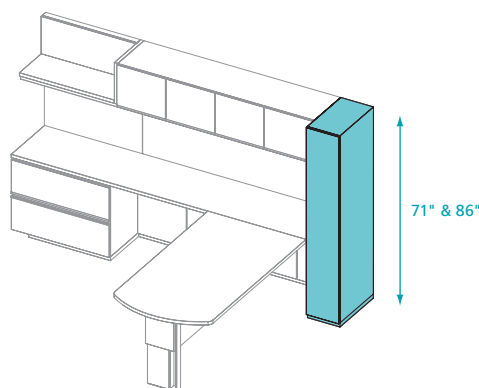
**End Support** is offered in either all paint or all veneer, except the base which can be specified in paint or veneer to match or contrast the unit.

## Planning – Tall Storage

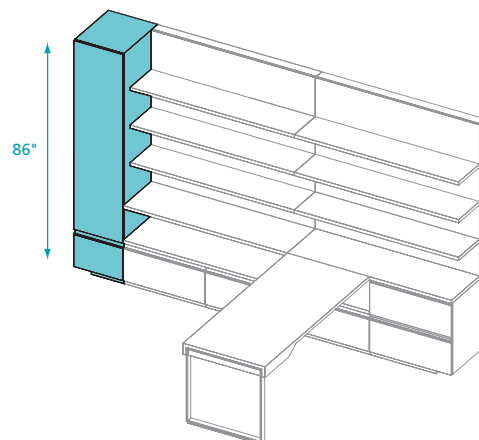
Apogee's Tall Storage fits with both Architectural and Casework Walls, and includes wardrobe and shelving units designed to increase the reference and personal storage capacity within the private office.

### Tall Storage Application

Tall Storage units are available in two heights (71" & 86"). Always place Tall Storage units at the end of an Architectural or Casework Wall, and always match its height to the height of the workwall.



Casework Wall



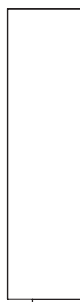
Architectural Wall

### Tall Storage Offering

Wardrobe units are offered in two styles and two widths (12" & 18"). Shelving units are offered in one width (18"). Both Wardrobe and Shelving units offer an inset or flush base as shown right.

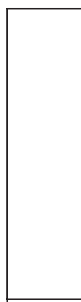
**Design Tip:** Combine the Wardrobe/ File unit with one-high lateral files to create a harmonious aesthetic as shown in the examples this section.

12" & 18"



Inset Base

12" & 18"



Flush Base

18"

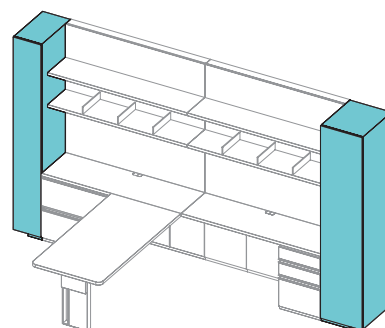
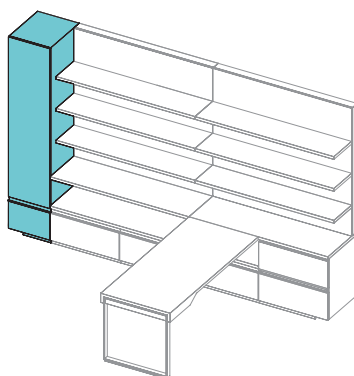


Inset Base

18"

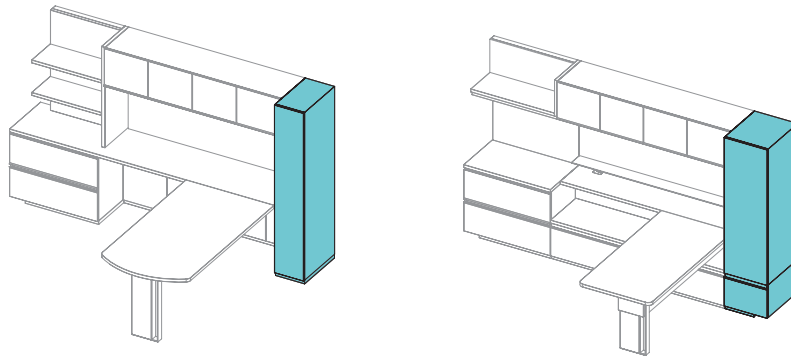


Flush Base



Architectural Wall Examples

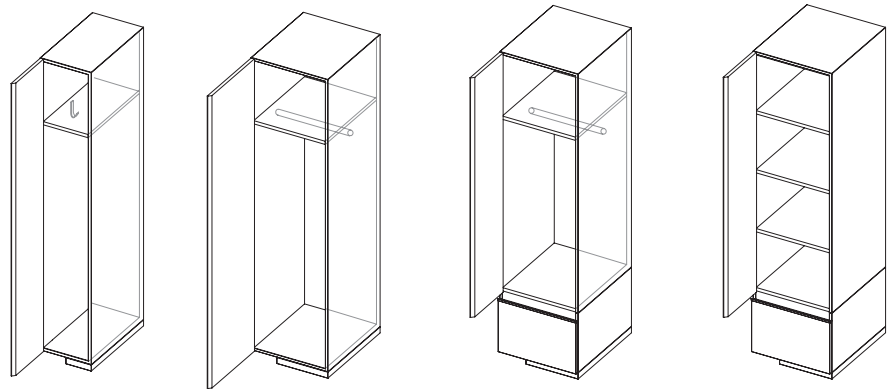
## Tall Storage Offering (cont.)



Casegood Wall Examples

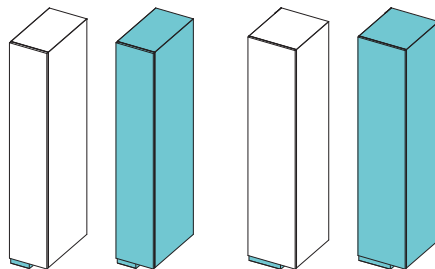
## Tall Storage Features

Wardrobe units feature a single fixed shelf with a coat hook (12"W units) or rod (18"W units) below. Shelving units feature adjustable shelves, and the lower drawer on both Tall Storage units accommodates letter and legal filing. These units also feature an integrated finger pull along the length of the door and width of the drawer.

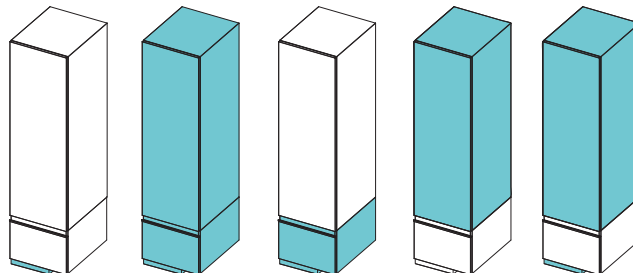


## Finishes + Materials

Tall Storage units can be specified in paint, veneer or a combination of these finishes. Two types of veneer are offered: double-cut (horizontal grain direction) or natural quartered (vertical grain direction).



**Wardrobe and Shelving** Tall Storage can be specified in all paint or all veneer, and the base can be specified in paint or veneer to match or contrast the unit above.



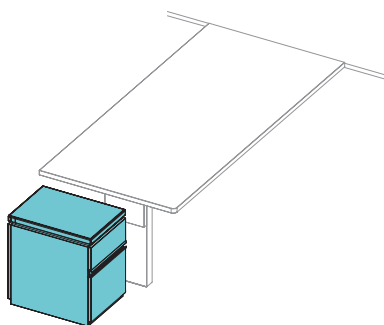
**Wardrobe/File** Tall Storage can be specified in all paint or all veneer, and the file drawer can be specified in all paint or all veneer to match or contrast the unit above. Select paint or veneer for the base to match or contrast the unit above.

## Planning – Accessories

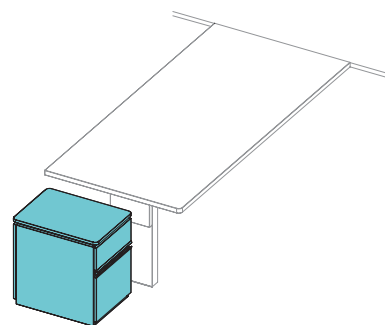
Apogee offers a variety of workflow and organizational accessories including Mobile Pedestals, Shuttles, Paper Trays, and a Desk Pad. The Shuttle stows under the desktop when not in use, and slides into the primary work zone bringing files, piles or supplies to the user.

### Mobile Pedestal Application

Apogee's Mobile Pedestal is offered in two styles to compliment post supported desks. Both units feature a utility/file drawer configuration and locking casters.



Cushion Top Mobile Pedestal

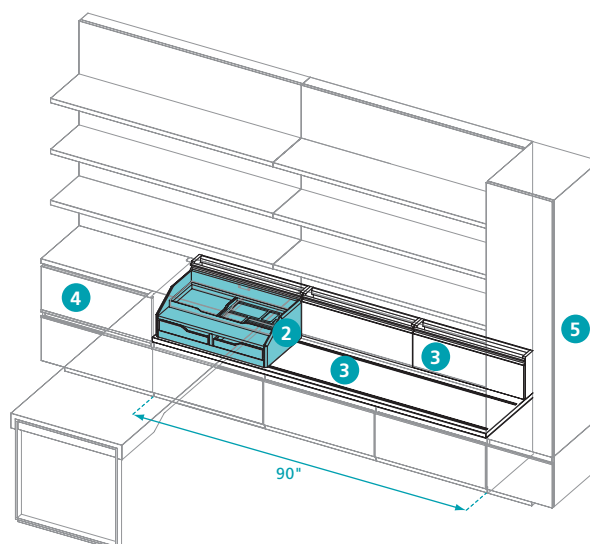


Wood Top Mobile Pedestal

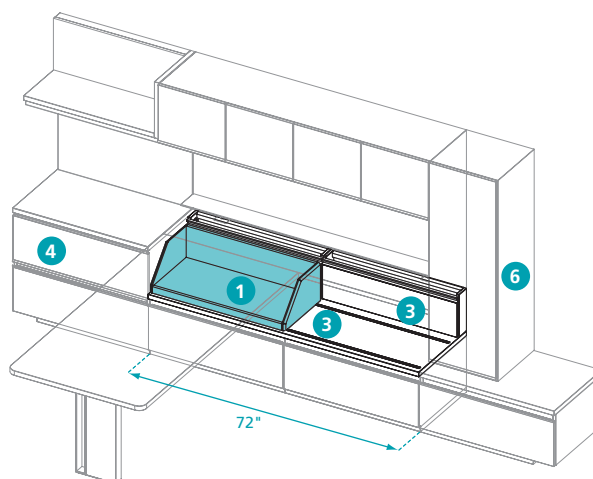
### Shuttle Application

The Shuttle works with both Architectural and Casework Walls, and sits atop the One-high Lateral File and a separately specified Workwall Top with recessed tracks. Available in four lengths (60, 72, 90 and 108 inches), these Workwall Tops are specified as one unit that includes the Access Panels. These unique Workwall Tops should always be placed between Two-high Lateral File, Tall Storage or Tower units as shown right.

- 1 Storage Shuttle
- 2 Piling Shuttle
- 3 Workwall Top and Access Panel, Partial-height
- 4 Two-high Lateral File
- 5 Tall Storage
- 6 Tower



Architectural Wall

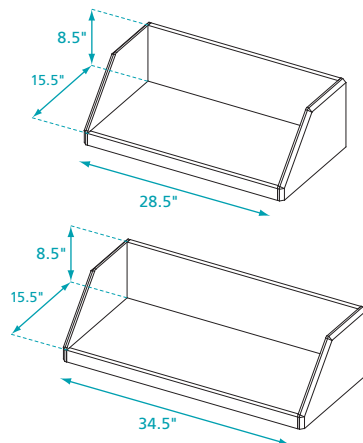


Casework Wall

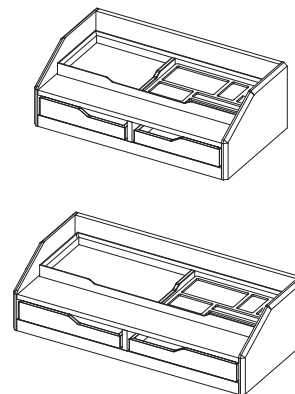
**Design Tip:** Shuttle should be the same or smaller width than the adjacent desk top depth. Example: Specify a 30"W Shuttle with a 30"D or 36"D desk top.

## Shuttle Offering

The Shuttle is available in two styles and two sizes (30"W & 36"W). The Storage Shuttle provides an open space to stow larger sized items. The Piling Shuttle features two niches with removable paper trays, and a divided organizer tray.



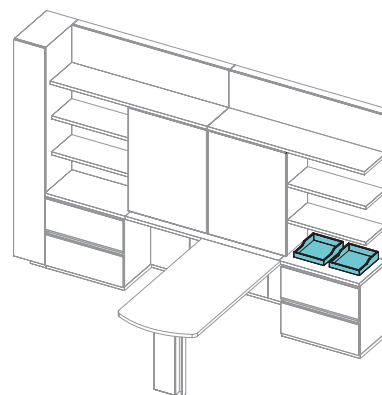
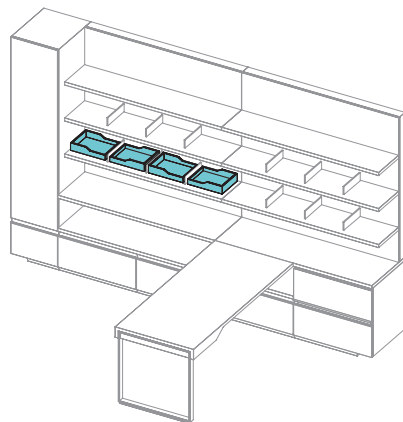
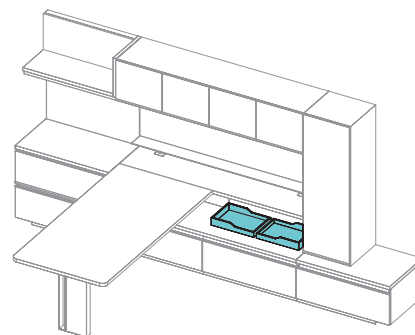
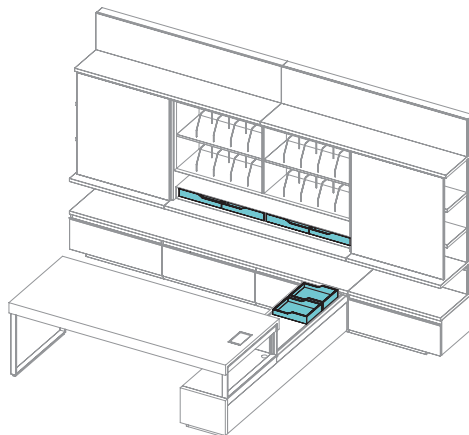
Storage Shuttle (with interior dimensions)



Piling Shuttle

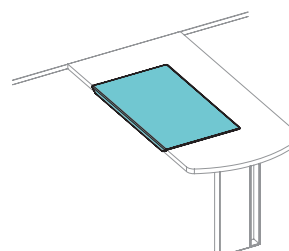
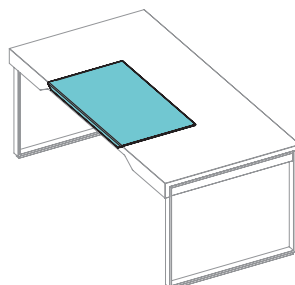
## Paper Tray Application

Apogee's Paper Trays are available in two sizes to fit either letter or legal documents. Paper trays are included with the Piling Shuttle and can also be specified separately. These flexible trays feature a felt underside, and can be placed in Workcenter niches and on all shelves or worksurfaces as shown in the examples right.



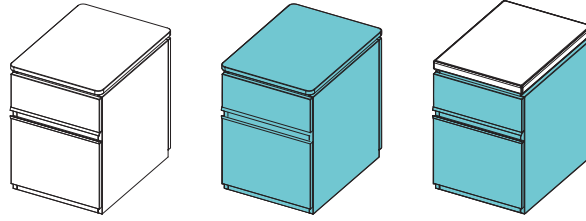
## Desk Pad Application

Apogee's leather Desk Pad (20"x34") features a wrapped edge to maintain alignment with the desk top, and fits on all Desk styles.

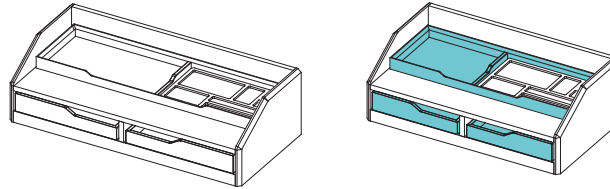


## Apogee

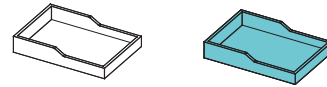
## Finishes + Materials



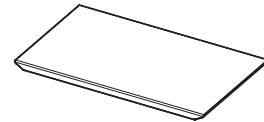
**Mobile Pedestal** cases can be all paint or all veneer. The drawer features an anodized aluminum pull. The cushion top is available in any JSI textile or COM.



**Shuttle** cases and upper organizer tray are available in all paint, and paper trays can be either paint or natural veneer to match or contrast the Shuttle case. The divided section of the organizer tray features a charcoal colored felt.



**Paper Trays** are available in a variety of paint colors, and any Apogee natural veneer. Felt undersides protect worksurface and shelf finish as paper trays are moved from place to place.



**Desk Pads** feature leather on the topside and underside, and can be specified in any standard JSI leather or COL.

Apogee designed by CSD Studio



[jsifurniture.com](http://jsifurniture.com)  
800.457.4511

812.482.3204 **O**  
812.482.1548 **F**

225 Clay Street • P.O. Box 231  
Jasper, Indiana 47547



J.MPS.AP0514.7500